



Product Overview

World class manufacturers of alarm, signalling, control and notification products for use in hazardous and industrial areas.



In today's intensely competitive marketplace, proven reliability and expertise combine with functionality to drive the ultimate purchasing decision. When you are working on a multi-million dollar construction project, you need a partner that can support you with tried-and-tested products as well as a full service and support package from initial system definition through to design and service. **Cooper MEDC** is dedicated to maximising both personnel and equipment safety by offering a comprehensive range of innovative notification solutions designed for potentially explosive atmospheres and harsh industrial and marine environments.

Proven solutions for harsh and hazardous environments

Designers and manufacturers of alarm, signal, control and communications equipment since 1975, Cooper MEDC has developed a range of products specifically designed for harsh environmental conditions and where there is a risk of explosion due to the presence of flammable atmospheres both offshore and onshore. The extensive range of manual, visual, audible alarms and loudspeakers has been developed in close collaboration with customers to deliver the best combination of performance and safety. Through its vast global presence, technical sales force and engineering experts, Cooper MEDC meets the demanding standards of a multitude of industries including: oil, gas, petrochemical, marine and mining.

Technical solutions and superior performance

Cooper MEDC has pioneered the use of glass reinforced polyester (GRP) in explosion-proof products to deliver solutions with reduced maintenance, extended lifetime and lower cost of ownership. Since 1975, the oil and gas industry has counted on Cooper MEDC for the most reliable and highly respected alarms and loudspeakers in the industry. Extensive quality certifications include ATEX, COST, UL, ULC, CSA, GOST R, GOST K, IECEx and Inmetro and demonstrate our commitment to maintaining our leadership position in the market.

Thousands of Products, Hundreds of Solutions, One Cooper

Within Cooper Industries' Safety division, Cooper MEDC's notification equipment is part of a comprehensive portfolio of solutions which also includes emergency lighting, security and fire detection as well as lighting fixtures and electrical installation materials.

Cooper Safety specialises in products designed to save lives and protect property in the most demanding industrial, residential and commercial environments worldwide. The company's high-quality brands have earned leadership positions in the markets we serve and that leadership is sustained through unparalleled sales support, market expertise and local availability. Cooper Safety is a division of Cooper Industries with manufacturing facilities in 23 countries and more than 25,000 people throughout the world.



How to use this Overview

This overview contains concise information on **Cooper MEDC** products for use in potentially explosive atmospheres, harsh industrial and marine environments.

To use this guide, refer to the product group of interest, read through the brief information and select the specific product for your application.

For more detailed information visit our website www.coopermedc.com where a detailed datasheet can be downloaded. Or alternatively contact our sales offices in the UK and the USA for a full catalogue.



Manual Alarm Call Points	6
Status Lights	9
Beacon / Strobes	12
Sounders / Horns	20
Combination Units	24
Loudspeakers	27
Detectors / Control / Distribution	31
Heavy Duty Industrial / Marine	35
Cable Glands / Accessories	38
North American Certified Products	42

Hazardous Area Guide

This information is intended as a guide only and further expert guidance should be sought before placing into service, maintaining or repairing any item of equipment in a Potentially Explosive Atmosphere.

Definition | Potentially Explosive Atmospheres exist where there is a risk of explosion due to mixtures of gas/air, vapour/air, dust/air or other flammable combinations. Where electrical equipment has to be used in these areas, it must be so designed and constructed such that it does not create sources of ignition capable of igniting these mixtures.

Area Classification | Process plants are divided into Zones (European and IEC method) or Divisions (North American method) according to the likelihood of a Potentially Explosive Atmosphere being present. Note: North American legislation now allows Zones to be used to classify areas, where this practice is used it follows the IEC Zone method.

European & IEC Classification	Definition of zone or division	North American Classification
Zone 0 (gases) Zone 20 (dusts)	An area in which an explosive mixture is continuously present or present for long periods	Class I Division 1 (gases) Class II Division 1 (dusts)
Zone 1 (gases) Zone 21 (dusts)	An area in which an explosive mixture is likely to occur in normal operation	Class I Division 1 (gases) Class II Division 1 (dusts)
Zone 2 (gases) Zone 22 (dusts)	An area in which an explosive mixture is not likely to occur in normal operation and if it occurs it will exist only for a short time	Class I Division 2 (gases) Class II Division 2 (dusts) Class III Division 1 (fibres) Class III Division 2 (fibres)

Gas Groups, Dusts and Fibres

There are two main gas groups, Group I – Mining only and Group II – Surface Industries.

These categories are used in European and I.E.C. groupings.

Group I is concerned only with underground mining where methane and coal dust are present.

Group II gases occurring in surface industries, are sub-grouped according to their volatility. This enables electrical equipment to be designed to less onerous tolerances if it is to be used with the least volatile gases.

Typical gas/ material	European/I.E.C. Gas Group	North American Gas Group
Methane	I	-
Acetylene	IIC	A
Hydrogen	IIC	B
Ethylene	IIB	C
Propane	IIA	D
Metal dust	-	E
Coal dust	-	F
Grain dust	-	G

ATEX

After 1st July 2003, the ATEX directive came into force and is a mandatory requirement for all equipment intended for use in Potentially Explosive Atmospheres within the E.U. All relevant MEDC equipment is covered by the date it comes into force and many are already certified. It should be noted also that MECHANICAL equipment is covered by the ATEX directive so for the first time items such as gearboxes will have to carry ATEX certification.

Temperature

To guard against hot surfaces igniting gases, all electrical equipment intended for use in Potentially Explosive Atmospheres is classified according to the maximum surface temperature it will reach in service (normally based on a surrounding ambient temperature of 40°C (102°F)).

Temperature Classification		Maximum Surface Temperature
European/I.E.C.	North American	
T1	T1	450° C
	T2	300° C
T2	T2A	280° C
	T2B	260° C
	T2C	230° C
	T2D	215° C
	T3	200° C
T3	T3A	180° C
	T3B	165° C
	T3C	160° C
	T4	135° C
T4	T4A	120° C
	T5	100° C
T5	T5	100° C
T6	T6	85° C

The equipment coding will be as the current practice plus an additional code as follows:

Ex II 2GD i.e.

Ex – Explosionproof in accordance with ATEX.

II – Group II surface industries

2 – Category 2 equipment (suitable for use in Zone 1) note:

Category 1 is suitable for Zone 0.

Category 3 is suitable for Zone 2.

G – suitable for atmospheres containing gas

D – suitable for atmospheres containing dust

Equipment will be CE marked when certified to ATEX.

For more information about hazardous areas, download the guide from www.coopermedc.com.

Types of Electrical Equipment Suitable for use in Potentially Explosive Atmospheres	European Area of use Designation Standard	IEC Area of use Designation Standard	USA Area of use Designation Standard
Different techniques are used to prevent electrical equipment from igniting explosive atmospheres. There are restrictions on where these different types of equipment can be used as follows:			
Flameproof Enclosure – An enclosure used to house electrical equipment, which when subjected to an internal explosion will not ignite a surrounding explosive atmosphere.	Zones 1 & 2 EExd EN60079-1	Zones 1 & 2 Exd IEC60079-1	Class I Divisions 1 & 2 – UL1203
Intrinsic Safety – A technique whereby electrical energy is limited such that any sparks or heat generated by electrical equipment is sufficiently low as to not ignite an explosive atmosphere.	Zones 0, 1 & 2 EExi EN60079-11	Zones 1 & 2 Exi IEC60079-11	Class I Divisions 1 & 2 – UL913
Increased Safety – This equipment is so designed as to eliminate sparks and hot surfaces capable of igniting an explosive atmosphere.	Zones 1 & 2 EExe EN60079-7	Zones 1 & 2 Exi IEC60079-7	– – –
Purged and Pressurised – Electrical equipment is housed in an enclosure which is initially purged to remove any explosive mixture, then pressurised to prevent ingress of the surrounding atmosphere prior to energisation.	Zones 1 & 2 EExp EN60079-2	Zones 1 & 2 Exp IEC60079-2	Class I Divisions 1 & 2 – NFPA496
Encapsulation – A method of exclusion of the explosive atmosphere by fully encapsulating the electrical components in an approved material.	Zones 1 & 2 EExm EN60079-18	Zone 1 & 2 Exm IEC60079-18	– – –
Oil Immersion – The electrical components are immersed in oil, thus excluding the explosive atmosphere from any sparks or hot surfaces.	Zone 1 & 2 EExo EN50015	Zones 1 & 2 Exo IEC60079-6	Class I Division 2 – UL698
Powder Filling – Equipment is surrounded with a fine powder, such as quartz, which does not allow the surrounding atmosphere to come into contact with any sparks or hot surfaces.	Zones 1 & 2 EExq EN50017	Zones 1 & 2 Exq IEC60079-5	– – –
Non-sparking – Sparking contacts are sealed against ingress of the surrounding atmosphere, hot surfaces are eliminated.	Zone 2 EExn EN60079-15	Zone 2 Exn IEC60079-15	– – –

Selection, Installation and Maintenance of Electrical Equipment Intended for use in Potentially Explosive Atmospheres
International and national standards are published giving details of requirements for the safe use of Electrical Equipment in Potentially Explosive Atmospheres as follows:

	International	Europe	U.S.A.
General Recommendations	IEC60079-14	EN60079-14	N.E.C. Chapter 5
Classification of Hazardous Areas	IEC60079-10	EN60079-10	N.E.C. Chapter 5
Inspection and Maintenance of Electrical Equipment	IEC60079-17	EN60079-17	-
Requirements for Flameproof Enclosures	IEC60079-14	EN60079-14	N.E.C. Chapter 5
Requirements for Intrinsically Safe Equipment	IEC60079-14	EN60079-14	N.E.C. Chapter 5
Requirements for Increased Safety Equipment	IEC60079-14	EN60079-14	N.E.C. Chapter 5
Requirements for Purged and Pressurised Equipment	IEC60079-14	EN60079-14	N.E.C. Chapter 5
Requirements for Non-Sparking Equipment	IEC60079-14	EN60079-14	-

Cooper MEDC advise that all Explosion-proof electrical equipment is maintained, by suitably trained personnel, in accordance with the Manufacturers' recommendations.

Any spare parts used should be purchased from the original Manufacturer and repairs should be carried out by the Manufacturer or under his supervision, in order that the item remains in conformance with the certification documents.



Manual Alarm Call Points

Cooper MEDC offer a range of manual alarm call points, in various materials covering push button and break glass versions.

Manual alarm call points are designed for the purpose of raising an alarm manually once verification of a fire or emergency condition exists, by operating the push button or break glass the alarm signal can be raised.

There are options for the inclusion of LED status indicators and addressable boards to give the unit an individually recognised location (or address) within the system. These manual call points are designed to meet global industrial and fire application standards.



Explosionproof & Weatherproof – Break Glass Call Point | BG

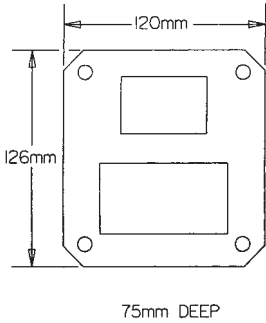

Certification	ATEX, UL, CSA, GOST 'R' & 'K', CQST, Inmetro, Russian fire approved
Intrinsically Safe	ATEX Ex II 1GD, EExia IIC T4
Increased Safety	ATEX Ex II 2GD, EExed(m) IIC T4 (T6)
Area Classification	Model dependant - refer to datasheet
Certified Ambient Temperature	-40°C to +50°C (EExia) -20°C to +50°C (EExed)
Ingress Protection	IP66 & 67
Material	Corrosion-free GRP
Entries	Up to 4 x 20mm or 16mm (NPT for UL)
Weight	1.2kg (varies with model)
Options	Body colour, LED, lift flap, series & EOL resistors, diodes, earth continuity, terminals, certification, tag & duty labels.



Explosionproof & Weatherproof – Break Glass Call Point | BG2

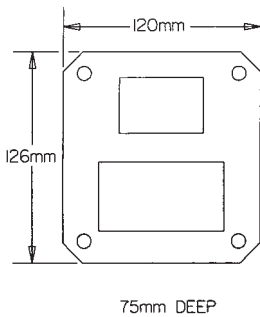

Certification	ATEX
Intrinsically Safe	ATEX Ex II 1GD, EExia IIC T4
Increased Safety	ATEX Ex II 2GD, EExed(m) IIC T4 (T6)
Area Classification	Model dependant - refer to datasheet
Certified Ambient Temperature	-40°C to +50°C (EExia) -20°C to +50°C (EExed)
Ingress Protection	IP66 & 67
Material	Corrosion-free GRP
Entries	2 x 20mm
Weight	1.2kg
Options	Lift flap, series & EOL resistors



Explosionproof & Weatherproof – Break Glass Call Point | BG3

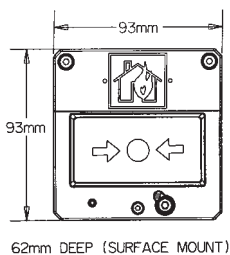

Certification	ATEX, CQST
Intrinsically Safe	ATEX Ex II 1G, EExia IIC T4
Area Classification	Model dependant - refer to datasheet
Certified Ambient Temperature	-55°C to +55°C (EExia)
Ingress Protection	IP66 & 67
Material	Corrosion-free GRP
Entries	2 x 20mm
Weight	0.5kg
Options	Body colour, LED, lift flap, series & EOL resistors, tag & duty labels.



PB | Push Button Call Point – Explosionproof & Weatherproof



Certification	Ex ATEX, UL*, CSA*, GOST 'R' & 'K', CQST, Inmetro, Russian fire approved
Intrinsically Safe	ATEX Ex II 1GD, EExia IIC T4
Increased Safety	ATEX Ex II 2GD, EExed(m) IIC T4 (T6)
Area Classification	Model dependant - refer to datasheet
Certified Ambient Temperature	-40°C to +70°C (EExia) -20°C to +50°C (EExed)
Ingress Protection	IP66 & 67
Material	Corrosion-free GRP
Entries	Up to 4 x 20mm or 16mm (NPT for UL)
Weight	1.2kg
Options	Body colour, LED, series & EOL resistors, diode, earth continuity (Not UL), turn & push, self reset, tag & duty labels.

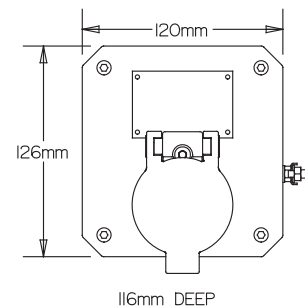

* Refer to North American section (pg 44)

SM87 BG | Break Glass Call Point – Explosionproof & Weatherproof



Certification	Ex ATEX, CSA, GOST 'R' & 'K', CQST, Inmetro, IECEx, Russian fire approved
Intrinsically Safe	ATEX Ex II 1G, Exia IIC T4
Flameproof	ATEX Ex II 2G, Exd IIC T5, T6
Area Classification	Zone 0, Zone 1 and Zone 2 use*
Certified Ambient Temperature	-55°C to +70°C -20°C to +55°C (LED) -20°C to +70°C
Ingress Protection	IP66 & 67
Material	Stainless Steel or Alloy
Entries	Up to 4 x 20mm or 25mm
Weight	3.8kg (Stainless Steel) 2.5kg (Alloy)
Options	Body colour, lift flap, LED, resistor, diode, 3 & 4 pole changeover switch, certification, tag & duty labels.

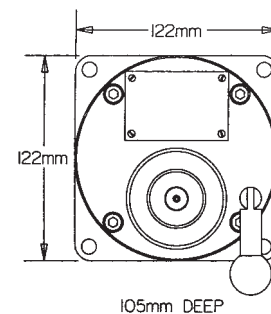

*Model dependant.

SM87 PB | Push Button Call Point – Explosionproof & Weatherproof



Certification	Ex ATEX, UL, CSA, GOST 'R' & 'K', CQST, Inmetro, IECEx, Russian fire approved
Intrinsically Safe	ATEX Ex II 1G, Exia IIC T4
Flameproof	ATEX Ex II 2G, Exd IIC T6
Area Classification	Zone 0, Zone 1 and Zone 2 use*
Certified Ambient Temperature	-55°C to +70°C -20°C to +55°C (LED) -20°C to +70°C
Ingress Protection	IP66 & 67
Material	Stainless Steel or Alloy
Entries	Up to 4 x 20mm or 25mm (NPT for UL)
Weight	3.8kg (Stainless Steel) 2.5kg (Alloy)
Options	Body colour, LED, resistor, diode, 3 & 4 pole changeover switch, certification, tag & duty labels.

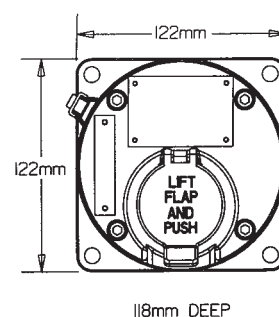

*Model dependant.

NEW PRODUCT • MEDC • NEW PRODUCT

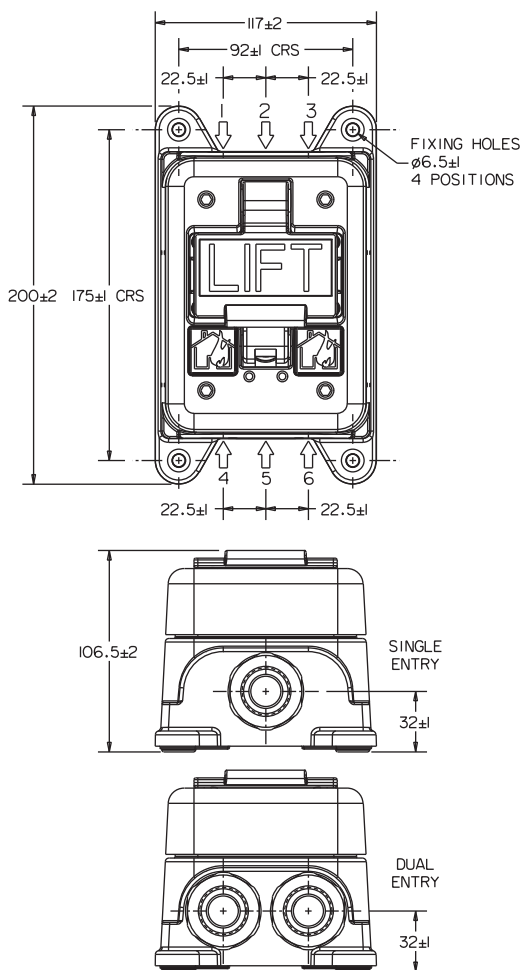

- Industry first IECEx Pull Handle Call Point
- All GRP corrosion free construction with retained 316L stainless steel cover screws
 - Suitable for both Cable and Conduit installations
 - Easy installation
- True double action pull handle, designed to work effortlessly with industrial PPE
 - IP66 & IP67 and an ambient temperature range of -55°C to +70°C

Explosionproof & Weatherproof – Pull Handle Call Point | PH1

Certification	ATEX, IECEx
Flameproof	Ex II 2 GD, EX d IIC T6, Ex tb IIIC T85°C
Area Classification	Zone 1 and Zone 2 use.
Certified Ambient Temperature	-55°C to +70°C
Ingress Protection	IP66 & IP67, NEMA 4X & 6
Material	Corrosion-free GRP
Entries	Up to 2 x M20 or M25, or up to 2 x ½" or ¾" NTP
Weight	2.6kg
Options	Series resistor, EOL resistor, Diode

Please contact Cooper MEDC Technical Sales for further information



Status Lights

Cooper MEDC offer a range of Status Lights designed for potentially explosive atmospheres and harsh environmental conditions.

Status lights are commonly found in oil, gas, petrochemical and other hazardous areas where multicoloured lamp combinations are used to identify the safety status of specific zones.



Explosionproof & Weatherproof - Xenon, Filament, Fluorescent & LED Status Lamps | SM87 SL

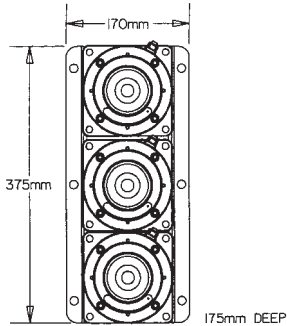

Certification	⊕ ATEX, GOST 'R' & 'K', CQST, Inmetro, CSA, IECEx
Flameproof	ATEX Ex II 2G, Exd IIC T4 (LED/Filament) ATEX Ex II 2G, Exd IIC T6 (Xenon/Fluorescent)
Area Classification	Zone 1 and Zone 2 use.
Certified Ambient Temperature	-20°C to +55°C (LED/Fluorescent) -55°C to +70°C* (Xenon/Filament)
Ingress Protection	IP66 & 67
Material	Stainless Steel or Alloy
Entries	Up to 3 x 20mm or 25mm
No. of Ways	Up to 5
Options	Body & lens colour, certification, tag & duty labels. *Model dependant, refer to data sheet.



Explosionproof & Weatherproof - Xenon, Filament & LED Status Lights | SL5

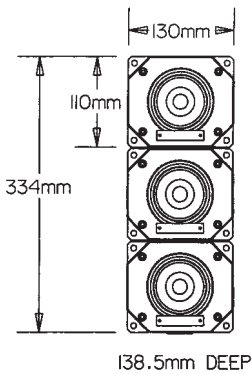

Certification	⊕ ATEX, CQST
Increased Safety	ATEX Ex II 2G, EExe(m) II T3, T4
Area Classification	Zone 1 and Zone 2 use.
Certified Ambient Temperature	-40°C to +55°C (Xenon/Filament) -40°C to +45°C (LED)
Ingress Protection	IP66 & 67
Material	Corrosion-free GRP
Entries	Up to 2 x 16mm or 20mm or 1 x 25mm or 32mm
No. of Ways	Up to 5
Options	Body & lens colour, certification, tag & duty labels.



Explosionproof & Weatherproof - Status Lights | SL15 Range

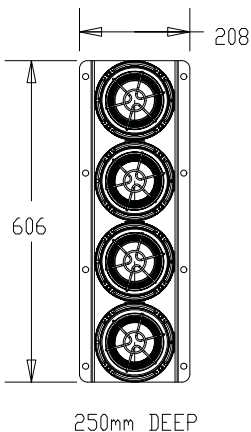

Certification	⊕ ATEX, IECEx & UL approved
Area Classification	Model dependant - refer to datasheet
Certified Ambient Temperature	-55°C to +70°C
Ingress Protection	IP66 & 67
Material	Corrosion-free GRP
Entries	Up to 2 x 1/2" or 2 x 3/4" entries. ATEX has M20 or M25.
No. of Ways	Up to 4
Options	Various flash rates available for xenon units. Various lens colours. Optional cast or wire lens guard.



ATEX/IECEx Version

XB11SL | Xenon, Filament & Fluorescent Status Lamps – *Explosionproof & Weatherproof*



Certification	ATEX, UL, Inmetro, CQST, IECEx
Flameproof	ATEX Ex II 2GD, Exd IIB T5, T6
Area Classification	Zone 1 and Zone 2 use.
Certified Ambient Temperature	-55°C to +70°C
Ingress Protection	IP66 & 67
Material	Corrosion-free GRP
Entries	1 x 20mm (NPT for UL)
No. of Ways	Up to 5
Options	Body & lens colour, tag & duty labels.

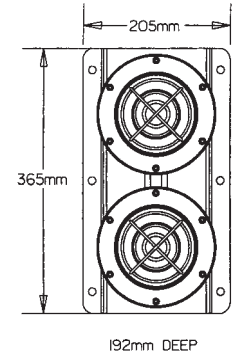

Status Lamps can also be configured using the high intensity XB4 range.

XB12SL | Xenon, Filament & Fluorescent Status Lamp – *Explosionproof & Weatherproof*



Certification	ATEX, UL, Inmetro, GOST, CQST, IECEx
Flameproof	ATEX Ex II 2G, Exd IIB T4, T5
Area Classification	Model dependant - refer to datasheet
Certified Ambient Temperature	-55°C to +70°C
Ingress Protection	IP66 & 67
Material	Corrosion-free GRP
Entries	1 x 20mm (NPT for UL)
No. of Ways	Up to 5
Options	Body & lens colour, tag & duty labels.

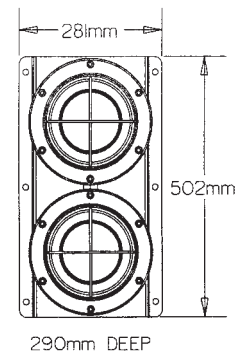



© BP p.l.c

Beacons / Strobes

Cooper MEDC offer a range of beacons including flashing, steady-state indicators and rotating units. These may be used to warn of potential hazards or indicate the status of plant items, gas and oil leaks, evacuation alerts and many more.

The signals may operate as stand-alone units or be incorporated into a wider system, such as a fire panel. Within this section there is a wide variety of output values and lens colours.



SM87 HXB | 5 Joule Flashing Xenon – Explosionproof & Weatherproof



Certification	ATEX, UL, CSA, GOST 'R' & 'K', CQST, Inmetro, IECEX, Russian fire approved
Flameproof	ATEX Ex II 2GD, Exd IIC T4, T5, T6
Area Classification	Model dependant - refer to datasheet
Certified Ambient Temperature	-55°C to +70°C (Exd)
Ingress Protection	IP66 & 67
Material	Stainless Steel or Alloy
Entries	Up to 4 x 20mm or 25mm (NPT for UL)
Weight	3.8kg (Stainless Steel) or 2kg (Alloy)
Options	Body & lens colour, EOL resistor, tel. & relay initiate, lens guard, tag or duty labels, flash rate, high temp. version (-40°C to +85°C) available, voltages 24-48V d.c., 110-254V a.c.

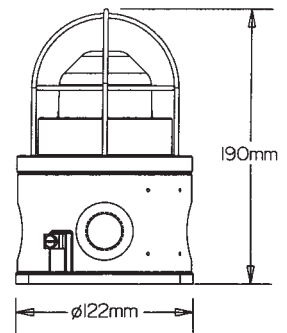

XB11 | 5 Joule Flashing Xenon – Explosionproof & Weatherproof



Certification	ATEX, UL, CQST, Inmetro, GOST 'R' & 'K', IECEX Dual listed ATEX/UL, Russian fire approved
Flameproof	ATEX Ex II 2GD, Exd IIB T4, T5, T6
Area Classification	Zone 1 and Zone 2 use.
Certified Ambient Temperature	-55°C to +70°C
Ingress Protection	IP66 & 67
Material	Corrosion-free GRP
Entries	2 x 20mm (NPT for UL)
Weight	2.5kg
Options	Body & lens colour, mounting, tel. initiate, lens guard, flash rate, earth continuity, voltages 24V d.c., 110V a.c., 240 V a.c.

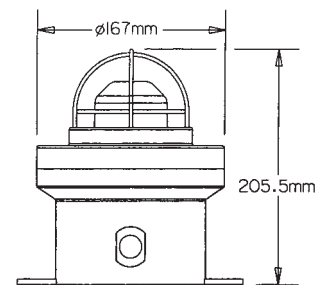

XB9 | 5 Joule Flashing Xenon – Explosionproof & Weatherproof



Certification	ATEX, Inmetro, IECEX, CQST, Russian fire approved
Flameproof	ATEX Ex II 2G, Exd IIC T5, T6
Area Classification	Zone 1 and Zone 2 use.
Certified Ambient Temperature	-55°C to +55°C
Ingress Protection	IP66 & 67
Material	Corrosion-free GRP
Entries	1 x 20mm or PG13.5
Weight	1.6kg
Options	Body & lens colour, tag or duty labels, voltages, flash rate, 24-48V d.c., 110-254V a.c.

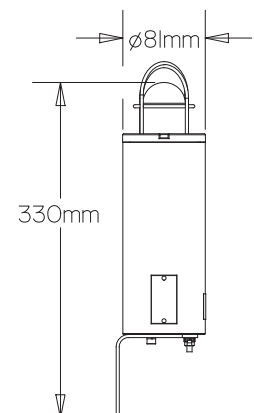

Explosionproof & Weatherproof -10 & 15 Joule Flashing Xenon | XB10

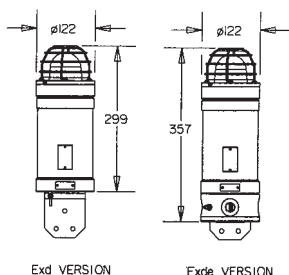

Certification	ATEX, GOST 'R', Inmetro, IECEx, Russian fire approved
Flameproof	ATEX Ex II 2G, Exd(e) IIB T4
Area Classification	Zone 1 and Zone 2 use.
Certified Ambient Temperature	*-55°C to +65°C 10 Joule *-55°C to +50°C 15 Joule
Ingress Protection	IP66 & 67
Material	Corrosion-free GRP
Entries	Up to 3 x 20mm or 2 x PG13.5
Weight	Exd 2.8kg Exde 3.6kg
Options	Body & lens colour, tel. initiate, earth continuity, flash rate, terminal chamber, voltages 24-48V d.c., 110-254V a.c.



*Exd version only, see data sheet for more information.

UL Hazardous & Ordinary Locations - 10 Joule Flashing Xenon | XB16

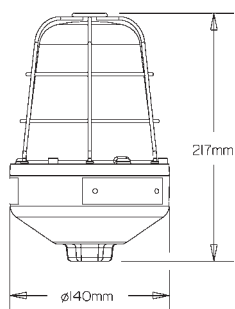

Certification	UL (1971 compliant)
Hazardous Locations	Class I, Div 2, Groups A-D Class II, Div 2, Groups F & G
Area Classification	Model dependant - refer to datasheet
Certified Ambient Temperature	-55°C to +70°C
Ingress Protection	IP66 & 67
Material	Corrosion-free GRP
Entries	1 x 3/4" NPT
Weight	1kg
Options	Body & lens colour, lens guard, tag & duty labels, relay initiate, flash rate, voltages 12-48V d.c., 110-254V a.c.



Explosionproof & Weatherproof -15 Joule Flashing Xenon | XB15

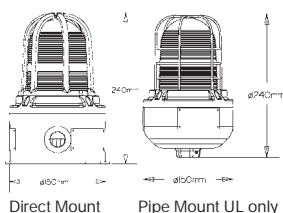

Certification	ATEX, UL, Inmetro, ULC, IECEx, CQST, Russian fire approved
Flameproof	ATEX Ex II 2GD, Exd IIC T4, T5, T6
Area Classification	Zone 1 and Zone 2 use.
Certified Ambient Temperature	-55°C to +70°C
Ingress Protection	IP66 & 67
Material	Corrosion-free GRP
Entries	Up to 3 x 20mm or 3 x 25mm (NPT for UL)
Weight	2.6-3kg
Options	Body & lens colour, relay & telephone initiate, flash rate, voltages 12-48V d.c., 110-254V a.c.



XB4 | 21 Joule Flashing Xenon – Explosionproof & Weatherproof



Certification	⊕ ATEX, UL, GOST 'R', Inmetro, IECEx, Russian fire approved
Flameproof	ATEX Ex II 2G, Exd(e) IIC T4, T5, T6
Area Classification	Zone 1 and Zone 2 use.
Certified Ambient Temperature	-55°C to +70°C
Ingress Protection	IP66 & 67
Material	Stainless Steel or Alloy
Entries	Up to 4 x 20mm or 25mm
Weight	15-16kg (Stainless Steel), 6.6-7.6kg (Alloy)
Options	Body & lens colour, lens guard, tag & duty labels, terminal chamber, initiation options, flash rate, voltages 24-48V d.c., 110-254V a.c.

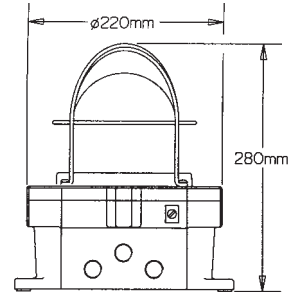

XB12 | 21 Joule Flashing Xenon – Explosionproof & Weatherproof



Certification	⊕ ATEX, UL, GOST 'R' & 'K', CQST, Inmetro, IECEx, Russian fire approved
Flameproof	ATEX Ex II 2G, Exd IIB T4, T5, T6
Area Classification	Zone 1 and Zone 2 use.
Certified Ambient Temperature	-55°C to +70°C
Ingress Protection	IP66 & 67
Material	Corrosion-free GRP
Entries	2 x 20mm (NPT for UL)
Weight	7.0kg
Options	Body & lens colour, lens guard, tag & duty labels, telephone initiation, flash rate, mounting method, earth continuity, voltages 24V d.c., 110-240V a.c.

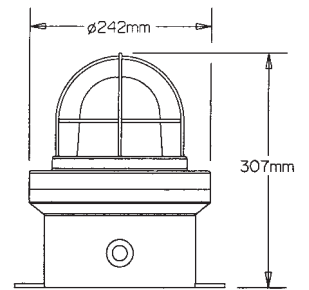

XB8 | 0.5 Joule Flashing Xenon – Explosionproof & Weatherproof



Certification	⊕ ATEX, GOST 'R', IECEx
Intrinsically Safe	ATEX Ex II 1G, Exia IIB/IIC T4
Area Classification	Zones 0, 1, 2 & safe area use.
Certified Ambient Temperature	-55°C to +60°C
Ingress Protection	IP66 & 67
Material	Corrosion-free GRP body, Polycarbonate lens
Entries	Up to 3 x 20mm via knockouts
Weight	1.4kg
Options	Body & lens colour, certification, tag & duty labels, voltages 12-24V d.c.

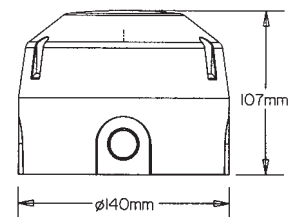

Weatherproof & Heavy Duty -10 Joule Flashing Xenon | XB13

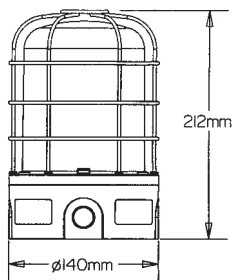

Area Classification	Weatherproof.
Operating Temperature	-55°C to +70°C
Ingress Protection	IP66 & 67
Material	Corrosion-free GRP body Polycarbonate lens
Entries	Up to 3 x 20mm via knockouts
Weight	1.1kg
Options	Body & lens colour, tag & duty labels, lens guard, telephone & relay initiate, single & dual flash mode, voltages 12 or 24V DC, 115 or 230V AC.



Explosionproof & Weatherproof - LU1/LU3 10 Watt Steady Filament/Fluorescent | SM87 LU1/LU3

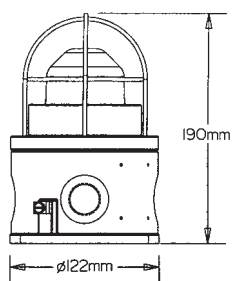

Certification	ATEX, UL, CSA, CQST, Inmetro, GOST 'R' & 'K', IECEx, Russian fire approved
Flameproof	ATEX Ex II 2GD, Exd(e) IIC T5, T6
Area Classification	Zone 1 and Zone 2 use.
Certified Ambient Temperature	*-55°C to +55°C -55°C to +70°C
Ingress Protection	IP66 & 67
Material	Stainless Steel or Alloy
Entries	Up to 3 x 20mm or 25mm (NPT for UL)
Weight	3.8kg (Stainless Steel), 2.5kg (Alloy)
Options	Body & lens colour, lens guard, tag or duty labels, terminal chamber, voltages 24-48V d.c., 110-254V a.c.



* Model dependant

Explosionproof & Weatherproof -10 Watt Steady Filament & Fluorescent | FB11 & FL11

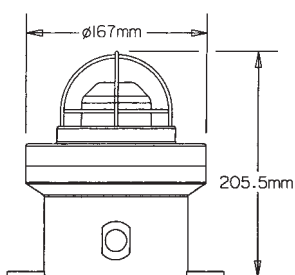

Certification	ATEX, UL, Inmetro, GOST 'R', IECEx, Russian fire approved
Flameproof	ATEX Ex II 2GD, Exd IIB T4, T5, T6
Area Classification	Zone 1 and Zone 2 use.
Certified Ambient Temperature	*-55°C to +70°C FB11 -20°C to +70°C FL11
Ingress Protection	IP66 & 67
Material	Corrosion-free GRP
Entries	2 x 20mm (NPT for UL)
Weight	2.8kg
Options	Body & lens colour, lens guard, tag & duty labels, lamp wattage, unit fixing, earth continuity, mounting method, voltages 24-48V d.c., 110-254V a.c.



* Model dependant

FB4 & FL4 | 100 Watt Steady Filament & 39 Watt Fluorescent – Explosionproof & Weatherproof



Certification	Ⓔ ATEX, UL, GOST 'R', Inmetro, IECEx
Area Classification	Zone 1 and Zone 2 use.
Flameproof	ATEX Ex II 2G, Exd(e) IIC T3, T4, T5, T6
Certified Ambient Temperature	*-55°C to +70°C (FB4 Exd) -50°C to +55°C (FB4 Exde) *-20°C to +70°C (FL4)
Ingress Protection	IP66 & 67
Material	Stainless Steel or Alloy
Entries	Up to 4 x 20mm or 25mm
Weight	14.9-17.3kg (Stainless Steel), 6.5 - 8.9kg (Alloy)
Options	Body & lens colour, lens guard, tag & duty labels, lamp wattage, relay initiate or terminal chamber, voltages 24-48V d.c., 110V d.c., 110-254V a.c.

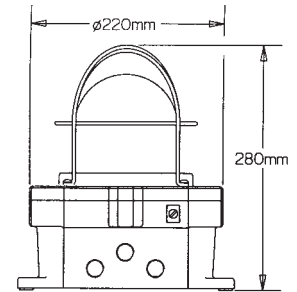

* Model dependant

FB12 & FL12 | 100 Watt Steady Filament & 39 Watt Fluorescent – Explosionproof & Weatherproof



Certification	Ⓔ ATEX, UL, GOST 'R', Inmetro, IECEx, Russian fire approved
Flameproof	ATEX Ex II 2GD, Exd IIB T3, T4, T5, T6
Area Classification	Zone 1 and Zone 2 use.
Certified Ambient Temperature	-55°C to +55°C (FB12) *-20°C to +70°C (FB11)
Ingress Protection	IP66 & 67
Material	Corrosion-free GRP
Entries	2 x 20mm (NPT for UL)
Weight	7.2 - 7.6kg
Options	Body & lens colour, lens guard, tag & duty labels, lamp wattage, unit fixing, earth continuity, mounting method, voltages 24-48V d.c., 110-254V a.c.

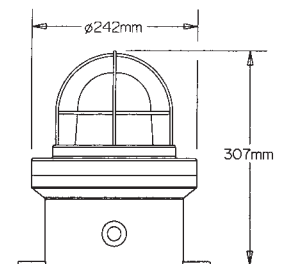

* Model dependant

FB15 | 60 Watt Steady Filament – Explosionproof & Weatherproof



Certification	Ⓔ ATEX, UL, Inmetro, GOST 'R', IECEx, Russian fire approved
Flameproof	ATEX Ex II 2GD, Exd IIC T3, T4
Area Classification	Zone 1 and Zone 2 use.
Certified Ambient Temperature	-55°C to +70°C
Ingress Protection	IP66 & 67
Material	Corrosion-free GRP
Entries	2 x 20mm (NPT for UL)
Weight	2.6 Kg (Pipe Mount) 3.0 Kg (Direct Mount)
Options	Body & lens colour, lens guard, tag & duty labels, lamp wattage, unit fixing, mounting method, voltages 24-48V d.c., 110-254V a.c.

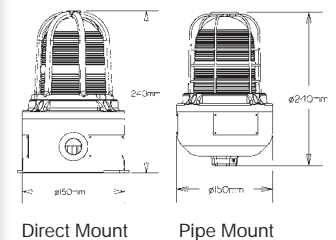

Explosionproof & Weatherproof – 200 Watt Steady Filament & 52 Watt Steady Fluorescent | **FB5 & FL5**

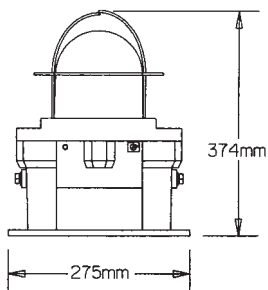

Certification	ATEX
Flameproof	ATEX Ex II 2G, EExd(e) IIB T3, T4
Area Classification	Zone 1 and Zone 2 use.
Certified Ambient Temperature	-20°C to +30°C (FB5) -20°C to +50°C (FL5)
Ingress Protection	IP66, 67 & 68
Material	Alloy
Entries	Up to 4 x 20mm or 25mm
Weight	11.6kg to 14.3kg
Options	Body colour, lens guard, mounting method, voltages 220-254V a.c.



Explosionproof & Weatherproof – Up to 192 Cd Steady or Flashing LED (Selectable) | **SM87 LED**

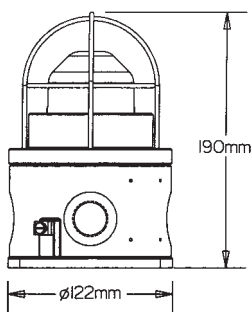

Certification	ATEX, UL, GOST, Imetro, CSA, COST, GOST 'R' & 'K', IECEx, Russian fire approved
Flameproof	ATEX Ex II 2GD, Exd IIC T6
Area Classification	Zone 1 and Zone 2 use.
Certified Ambient Temperature	-20°C to +55°C
Ingress Protection	IP66 & 67
Material	Stainless Steel or Alloy
Entries	Up to 3 x 20mm or 25mm
Weight	4.5kg (Stainless Steel), 2.5kg (Alloy)
Options	Body & lens colour, lens guard, tel & relay initiate, EOL resistor, terminal chamber, voltages 24-48V d.c..



Energy efficient LED product

Explosionproof & Weatherproof – 5 Joule Sequenced & 70 Watt Rotating | **XB5 & TH5**

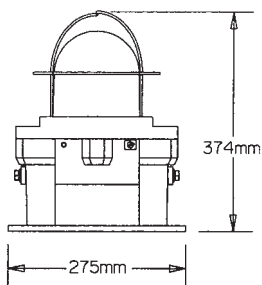

Certification	ATEX
Flameproof	ATEX Ex II 2G, EExd(e) IIB T4, T6
Area Classification	Zone 1 use.
Certified Ambient Temperature	-20°C to +55°C (TH5) -20°C to +40°C (XB5)
Ingress Protection	IP66, 67 & 68
Material	Alloy
Entries	Up to 4 x 20mm or 25mm – Exe only
Weight	14.6 - 15.9kg
Options	Body & lens colour, lens guard, tag label, terminal chamber, rotational speed, voltages *12-48V d.c., 110-254V a.c.



*See datasheet for voltage option for TH5.

HS5 & MF5 | 70 Watt Sodium/80 Watt Mercury Fluorescent – Explosionproof & Weatherproof



Certification	ATEX, CSA (HS5 only)
Flameproof	ATEX Ex II 2G, EExd(e) IIB T3, T4
Area Classification	Zone 1 and Zone 2 use.
Certified Ambient Temperature	-20°C to +40°C
Ingress Protection	IP66, 67 & 68
Material	Alloy
Entries	Up to 4 x 20mm or 25mm
Weight	12.9 - 14.0kg
Options	Body colour, lens guard, tag label, terminal chamber, mounting method, voltages 220-254V a.c.

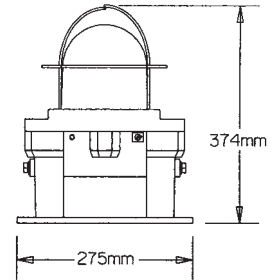

TH12 | 55 Watt/70 Watt Rotating Beacon – Explosionproof & Weatherproof



Certification	ATEX, GOST 'R', Inmetro, IECEx
Flameproof	ATEX Ex II 2G, Exd IIB T3, T4
Area Classification	Zone 1 and Zone 2 use.
Certified Ambient Temperature	-55°C to +70°C
Ingress Protection	IP66 & 67
Material	Corrosion-free GRP
Entries	2 x 20mm
Weight	7.6kg
Options	Body & lens colour, lens guard, tag & duty labels, flash rate, mounting method, earth continuity, voltages 24V d.c. 110-240V a.c.

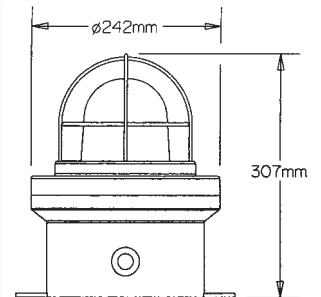



Sounders / Horns

Cooper MEDC Sounders and Horns feature a variety of tone settings, voice messaging or traditional bells. Sounders and Horns are used to warn of potentially dangerous situations or to relay instructions.

In addition the alarms may operate as stand-alone units or be incorporated into a hazard warning system. A wide variety of sound output levels and other options are also available. The Sounders and Horns output in dB(A) is measured to European standards at 1 metre.



DB1 | 113dB(A) Sounder – *Explosionproof & Weatherproof*



Certification	ATEX, UL, GOST 'R', Inmetro, IECEx, Russian fire approved
Flameproof	ATEX Ex II 2G, Exd IIB T5, T6
Area Classification	Zone 1 and Zone 2 use.
Certified Ambient Temperature	*-20°C to +70°C
Ingress Protection	IP66
Material	Stainless steel or alloy
Entries	Up to 3 x 20mm or 25mm
Weight	*5.6-12.7kg (Stainless Steel), 3.5-8.3kg (Alloy)
Options	Body colour, tag & duty labels, two stage (DB1P) alarms, high output (DB1HP), tel, relay or remote initiate, EOL resistor, certification, voltages 12-48V d.c., 110V a.c., 240V a.c.

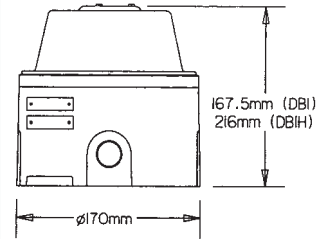

*Model dependant

DB3 | 118dB(A) Sounder – *Explosionproof & Weatherproof*



Certification	ATEX, UL, GOST 'R' & 'K', CQST, Inmetro, IECEx, Dual listed ATEX/UL, Russian Fire approved
Flameproof	ATEX Ex II 2GD, Exd(e) IIC T4, T5
Area Classification	Zone 1, Zone 2 and non-Ex use.
Certified Ambient Temperature	*-20°C to +70°C (standard) *-55°C to +70°C (low temp)
Ingress Protection	IP66 & 67
Material	Corrosion-free GRP
Entries	Up to 2 x 20mm
Weight	5.0kg
No. of Tones	27 user selectable tones and 5 optional programmable spaces.
Options	Body colour, tag & duty labels, two stage alarm (DB3P), low temperature version available, EOL resistor, certification, terminal chamber voltages 12-48V d.c., 110V-254V a.c.

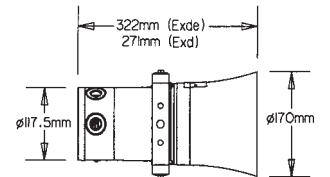

*Model dependant

DB3V | 110dB(A) Voice Sounder – *Explosionproof & Weatherproof*



Certification	ATEX, UL, GOST 'R' & 'K', CQST, Inmetro, IECEx, Russian fire approved
Flameproof	ATEX Ex II 2GD, Exd(e) IIC T4, T5
Area Classification	Zone 1, Zone 2 and non-Ex use.
Certified Ambient Temperature	*-20°C to +70°C (standard) *-55°C to +70°C (low temp)
Ingress Protection	IP66 & 67
Material	Corrosion-free GRP
Entries	Up to 2 x 20mm
Weight	5.0kg
Speech Duration	Up to 20 seconds repeatable
Options	Body colour, tag & duty labels, low temperature version available, EOL resistor, record feature, certification, terminal chamber, 'mechanical bell' sound version, voltages 12-48V d.c.

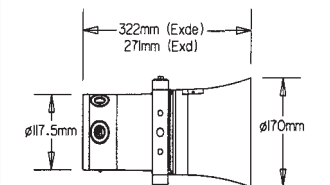

*Model dependant

Explosionproof & Weatherproof -103dB(A) Sounder | DB5

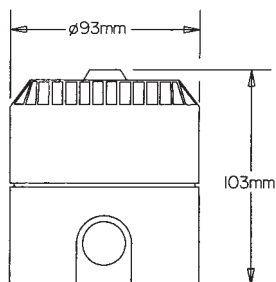

Certification	⊕ ATEX, CSA, FM Approved, Inmetro, IECEx, Russian fire approved
Intrinsically Safe	ATEX Ex II 1G & Ex1 M1, Exia IIC T4
Area Classification	Zone 0, Zone 1 and Zone 2 use.
Certified Ambient Temperature	-20°C to +55°C
Ingress Protection	IP65
Material	Corrosion-free ABS
Entries	Up to 2 x 20mm via knockouts
Weight	0.3kg
No. of Tones	26
Options	Body colour, tag labels, certification, voltages 12V-24V d.c.



Explosionproof & Weatherproof -110dB(A) Sounder | DB7

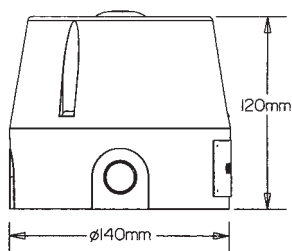

Certification	⊕ ATEX, GOST 'R', Russian fire approved
Intrinsically Safe	ATEX Ex II 1G, EExia IIB/IIC T4
Area Classification	Zones 0, 1, 2 and safe area use.
Certified Ambient Temperature	-55°C to +70°C
Ingress Protection	IP66 & 67
Material	Corrosion-free GRP
Entries	Up to 3 x 20mm via knockouts
Weight	1.0kg
No. of Tones	27
Options	Certification, body colour, duty & tag labels, voltages 12-24V d.c.



Weatherproof & Heavy Duty -110dB(A) Sounder | DB12

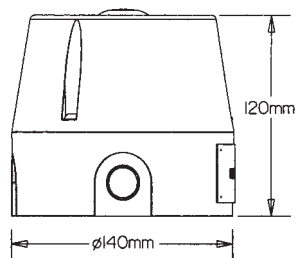

Area Classification	Weatherproof.
Operating Temperature	-55°C to +70°C
Ingress Protection	IP66 & 67
Material	Corrosion-free GRP
Entries	Up to 3 x 20mm via knockouts
Weight	1kg
No. of Tones	27 + 5 programmable
Options	Body colour, tag & duty labels, voltages 12V & 24V d.c.



DB15 | 117dB(A) Sounder – *Weatherproof & Heavy Duty*



Area Classification	Weatherproof.
Operating Temperature	-55°C to +70°C
Ingress Protection	IP66 & 67
Material	Corrosion-free GRP
Entries	2 x 20mm
Weight	2.6kg
No. of Tones	27 + 5 programmable
Options	Painted grey, tag & duty labels, two stage alarm (DB15P) version, earth continuity, EOL resistor, voltages 12-48V d.c., *110-254V a.c.

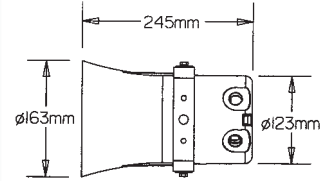

*Not available in a.c. versions for DB15P.

DB6 | 109dB(A) Bell – *Explosionproof & Weatherproof*



Certification	 ATEX, Inmetro, IECEx, Russian fire approved
Flameproof	ATEX Ex II 2G, Exd IIB T5
Area Classification	Zone 1 and Zone 2 use.
Certified Ambient Temperature	-20°C to +55°C
Ingress Protection	IP65
Material	Cast Iron
Entries	2 x 20mm
Weight	11kg
Options	Body colour, tag labels, voltages 24V d.c., 240V a.c.

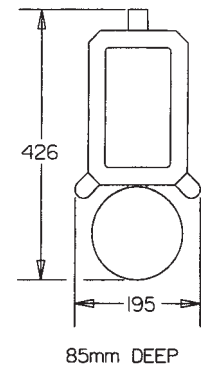



Combination Units

Cooper MEDC combination units are designed for the purpose of audio and visual awareness in an emergency situation.

Our range of combination units are suitable for use in harsh environmental conditions found offshore and onshore in the oil, gas and petrochemical industries.



CU 1 | 5 & 10 Joule Flashing Xenon / Sounder – *Explosionproof & Weatherproof*



Certification	⊕ ATEX, GOST 'R' & 'K', Inmetro, Russian fire approved
Flameproof	ATEX Ex II 2G EExd(e) IIB T3
Area Classification	Zone 1, Zone 2 & non-Ex use.
Certified Ambient Temperature	-50°C to +70°C*
Ingress Protection	IP66 & 67
Material	Corrosion-free GRP
Entries	Up to 2 x 25mm
Weight	6.5kg approx
Options	Body & lens colour, tel. initiate, earth continuity, flash rate, voltages 24–48V d.c. 110–254V a.c.

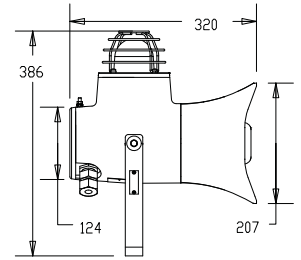

*High Temperature Unit, See data sheet for other versions.

DB3 / XB11 | 5 Joule Flashing Xenon / Sounder – *Explosionproof*



Certification	⊕ ATEX, UL, IECEx, GOST 'R' & 'K', CQST, Dual Listed ATEX & UL, Inmetro, Russian fire approved
Flameproof	ATEX: Ex II 2GD, Exd IIB T4, T5. UL: Class I, Div. 1, Groups C & D.
Area Classification	Zone 1 & Zone 2.
Voltage	24V d.c., 110V a.c., 240V a.c.
Beacon	Standard: XB11 (Xenon 5J). Option: Filament (10W). Fluorescent (≤10W).
Sounder	Standard: DB3 (long flare) ≤115dBA at 1 metre. Option: DB3 (short flare) ≤108dBA at 1 metre.
Dimensions (mm)	420 (height) x 220 (width) x 337 (depth).
Options	Refer to data sheet. Specify when ordering.

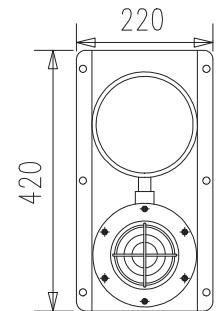

416mm MAX DEEP

DB1 HP / SM87 HXB | 5 Joule Flashing Xenon / Sounder – *Explosionproof*



Certification	⊕ ATEX, UL, IECEx, GOST 'R', Inmetro, Russian fire approved
Flameproof	ATEX: Ex II 2G, Exd IIB T3, T4, T5, T6. UL: Class 1, Div. 2, Group C & D.
Area Classification	Zone 1 and Zone 2.
Voltage	24V d.c., 110V a.c., 240V a.c.
Beacon	Standard: SM87 (Xenon 5J).
Sounder	Option: Filament (10W). Fluorescent (≤10W). Standard: DB1 P ≤ 106dBA at 1 metre
Dimensions (mm)	Option: DB1 HP ≤ 110dBA at 1 metre
Options	351 (height) x 228 (width) x 205 (depth). Refer to data sheet. Specify when ordering.

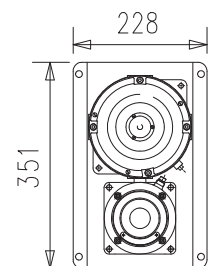

DB1 DEEP 182.5mm
DB1H DEEP 231mm

Explosionproof - 5 Joule Flashing Xenon / Sounder | DB3 / SM87 HXB

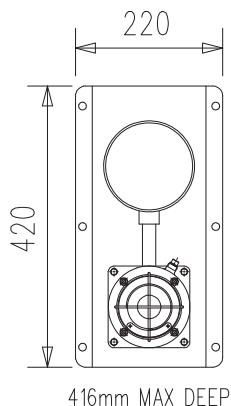

Certification	ATEX, UL, IECEx, GOST 'R' & 'K', CQST, Inmetro, Russian fire approved
Flameproof	ATEX: Ex II 2G, Exd IIC T3, T4, T5. UL: Class 1, Div. 2, Group C & D.
Area Classification	Zone 1 and Zone 2.
Voltage	24V d.c., 48V d.c., 240V a.c.
Beacon	Alloy or Stainless Steel.
Sounder	Corrosion-free GRP
Beacon	Standard: SM87 (Xenon 5J).
Sounder	Option: Filament (10W). Fluorescent ($\leq 10W$). LED. ($\leq 192cd$) Standard: DB3 (long flare) $\leq 115dB(A)$ at 1 metre. Option: DB3 (short flare) $\leq 108dB(A)$ at 1 metre. (Note: Close coupled unit only available ATEX certified).
Dimensions (mm)	420 (height) x 220 (width) x 337 (depth).
Options	Refer to data sheet. Specify when ordering.



Heavy Duty Industrial Marine - 10 Joule Flashing Xenon / Sounder | DB12 / XB13

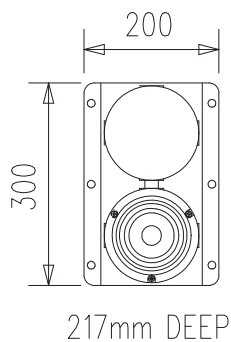

Applications	Harsh Industrial & Marine Environments.
Area Classification	Model dependant - refer to datasheet
Voltage	12V, 24V d.c., 110V, 240V a.c.
Beacon	Standard: XB13 (Xenon 10J).
Sounder	Standard: DB12 110dB(A) at 1 metre.
Dimensions (mm)	300 (height) x 195 (width) x 220 (depth).





Loudspeakers

Cooper MEDC's range of hazardous, heavy duty, industrial and commercial loudspeakers are designed to meet the requirements for public address, voice alarm (evacuation) and background music. The loudspeakers can generally operate as stand-alone units, or as part of 100 or 70 volt line systems.

Additionally a wide range of sound output levels (dB / Watts) are available. The loudspeakers sound output in dB(A) is measured to European standards at 1 watt / 1 metre.



Explosionproof & Weatherproof – 8 - 25 Watt Loudspeaker | DB4

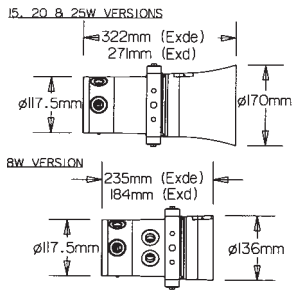

Certification	⊕ ATEX, UL, GOST 'R' & 'K', Inmetro, CQST, Russian fire approved
Flameproof	ATEX Ex II 2GD, Exd(e) IIC T4, T5
Area Classification	Zone 1, Zone 2 & non-Ex use.
Certified Ambient Temperature	*-20°C to +70°C (standard) -55°C to +70°C (low temp unit)
Ingress Protection	IP66 & 67
Material	Corrosion-free GRP
Output	107 dBA at 1W at 1 metre 119 dBA at 25W at 1 metre
Entries	Up to 2 x 20mm
Weight	5.0kg
Tappings @ 25 watts	25, 12.5, 6, 4, 2, 1
Options	Power (8W, 15W, 20W, 25W), body colour, tag & duty labels, BS5839, part 8 compliance, certification, terminal chamber, transformer voltage



*Model dependant

Explosionproof & Weatherproof – 8 & 15 Watt Loudspeaker | DB10

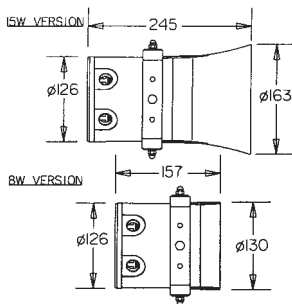

Certification	⊕ ATEX, GOST 'R' & 'K', CQST*, Inmetro*, IECEx, Russian fire approved
Flameproof & Increased Safety	ATEX Ex II 2G, Exde IIB & H2/IIC T4, T5, T6
Area Classification	Zone 1, Zone 2 & non-Ex use.
Certified Ambient Temperature	-55°C to +70°C
Ingress Protection	IP66 & 67
Material	Corrosion-free GRP
Output	105 dBA at 1W 1 metre 115 dBA at 15W at 1 metre
Entries	Up to 2 x 20mm
Weight	3.2kg (model dependant)
Tappings @ 15 Watts	15, 8, 4, 2, 1, 0.5, 0.25.
Options	Body colour, tag & duty labels, transformer voltage



15 Watt version
(8 Watt version has short flare)

* Please Contact Cooper MEDC Technical Sales

DB14 | 15 Watt Loudspeaker – *Weatherproof & Heavy Duty*



Area Classification	Weatherproof.
Ambient Operating Temperature	-55°C to +70°C
Ingress Protection	IP66 & 67
Material	Corrosion-free GRP
Output	107 dBA at 1W at 1 metre 117 dBA at 15W at 1 metre
Entries	2 x 20mm
Weight	2.6kg
Tappings	15, 7.5, 5, 4, 2, 0.8
Options	Painted grey, tag & duty labels, transformer voltage, BS 5839, part 8 compliance, earth continuity

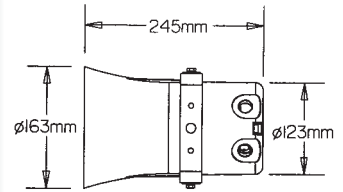

DB16 | 25 and 30 Watt Loudspeaker – *Explosionproof & Weatherproof*



Certification	ATEX, UL, GOST 'K', Inmetro, Russian fire approved
Flameproof & Increased Safety	ATEX Ex II 2G, EExde IIB T3 ATEX Ex II 2GD, EExde IIC T110°C
Area Classification	Zone 1, Zone 2 & non-Ex use.
Certified Ambient Temperature	-50°C to +65°C (25W) -50°C to +40°C (30W)
Ingress Protection	IP66 & 67
Material	Corrosion-free GRP
Output	IIB version: 1W/1m is 110dBA 25W/1m is 121dBA 30W/1m is 122dBA
See data sheet for additional output	
Entries	IIC version: 3dBA less than IIB versions
Weight	Up to 2 x 20mm or 2 x 25mm
Tappings @ 30 Watts	5.5kg
Options	30, 25, 12, 6, 4, 2 Body colour, 30W or 25W, transformer, tag & duty labels.

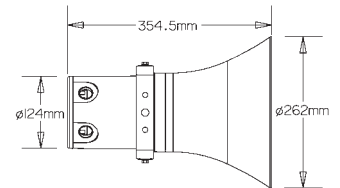

Explosionproof & Weatherproof – 8 & 4 Watt Loudspeaker | DB20 & DB20C

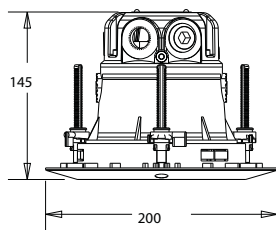

Certification	ATEX, IECEx, GOST 'R' and 'K', Inmetro, Russian fire approved
Flameproof and Increased Safety	ATEX Ex II 2G, Exde IIB T3, T4 ATEX Ex II 2GD Exde IIC T4, T5
Area Classification	Zone 1 & 2 (and Zone 21 & 22 : IIC version)
Certified Operating Temperature	-55°C to +70°C (DB20) -50°C to +70°C (DB20C)
Ingress Protection	IP66/67
Main body material	Corrosion-free GRP and ABS (DB20C)
Output IIC version	110 dB(A) (DB20) 100 dB (DB20C) at 1W at 1 metre 106 dB(A) at 4W at 1 metre 109 dB(A) at 8W at 1 metre
IIB version	3 dB(A) higher than IIC versions
Entries	2 x 20mm
Dimensions / Weight	L137 x Ø124mm / 1.5kg
Tappings @ 4 Watts	4, 2, 1, 0.75, 0.38, 0.2
Tappings @ 8 Watts	8, 4, 2, 1.5, 0.75, 0.4



Available in stirrup or ceiling mount



Detectors, Controls, Distribution

Here at Cooper MEDC we offer standard and bespoke control and distribution units for harsh and hazardous areas.

The control units are designed with convenient operation, safety and reliability in mind. As a leading manufacturer of hazardous area and explosion proof equipment, Cooper MEDC can provide hazardous and safe area control units in a range of dimensions to suit your required specification.



Explosionproof & Intrinsically Safe – Heat Detector | HD1

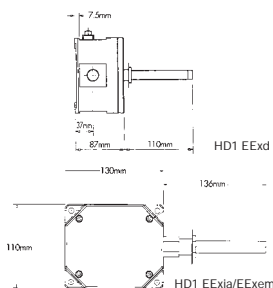

Certification	ATEX, GOST 'R' & 'K', CQST, Inmetro, Dual listed ATEX/UL, Russian Fire approved
Flameproof	ATEX Ex II 2G, EExd IIB T6
Increased Safety	ATEX Ex II 2G, EEEx II T6
Intrinsically Safe	ATEX Ex II 1G, EExia IIC T6
Area Classification	Zone 0, Zone 1 and Zone 2 use.
Certified Ambient Temperature	-20°C to +125°C EExd (T3) ATEX/GOST 'R' -20°C to +55°C EExd (T6)/EEExem
Ingress Protection	-55°C to +55°C EExia
Material	IP66 & 67
Temperature Settings	Marine Grade Alloy (EExd)
Entries	Corrosion-free GRP (EExia/EEExem)
Weight	140°F to 725°F (60°C to 385°C)
Options	2 x 20mm 1.1-2.0kg (model dependant) Enclosures, guard, colour, tag and duty labels, temperature setting. Series and EOL resistors, blanking plugs.



EExd
EExia/EEExem

Explosionproof & Weatherproof – GRP Junction Boxes | JB10 & JB11

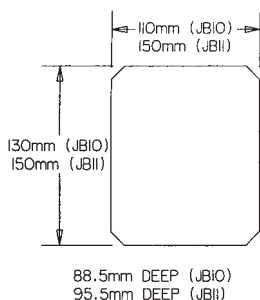

Certification	ATEX, UL
Increased Safety	ATEX Ex II 2G, EExe(m) II T3, T4, T5, T6
Area Classification	Zone 1 & 2 use.
Certified Operating Temperature	-55°C to +55°C (model dependant)
Ingress Protection	IP66 & 67
Material	Corrosion-free GRP
Entries	Multiple entries per face *
Weight	1.1kg JB10 approx 1.8kg JB11 approx
Options	Body colour, tag label, terminals, external earth, gland continuity, LED, stainless steel fittings, side cable entries, high temp. version (up to +125°C)



* Refer to datasheet

Explosionproof & Weatherproof – Control Units | GHG 41181

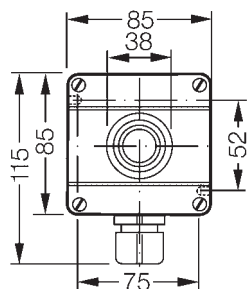

Certification	ATEX, UL
Increased Safety	ATEX Ex II 2GD, EExed IIC T6
Area Classification	Zones 1,2 and safe area.
Certified Ambient Temperature	-55°C to +50°C, Versions with switch -55°C to +45°C
Ingress Protection	IP65 & 66*
Material	Impact Resistant Thermo Plastic
Entries	1x M20 Bottom entry as standard
Weight	Approx. 0.5kg (model dependant)
Options	Pushbuttons, emergency stop, rotary switches & block, potentiometer, lamps, key switch, gold contact block.



*Dependant on version

GHG 41182 | Control Units – *Explosionproof & Weatherproof*



*Dependant on version

Certification	Ⓔ ATEX, UL
Increased Safety	ATEX Ex II 2GD, EExed IIC T6
Area Classification	Zones 1,2 and safe area.
Certified Ambient Temperature	-55°C to +50°C, Versions with switch -55°C to +45°C
Ingress Protection	IP65 & 66*
Material	Impact Resistant Thermo Plastic
Entries	1x M20 Bottom entry as standard
Weight	Approx. 0.5kg (model dependant)
Options	Pushbuttons, emergency stop, contact block, padlockable, rotary switches & block, potentiometer, lamps, gold contact block, key switch.

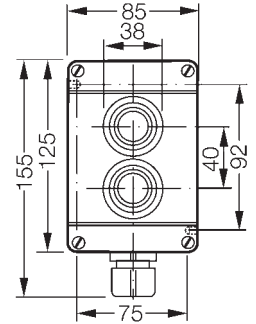

GHG 41183 | Control Units – *Explosionproof & Weatherproof*



*Dependant on version

Certification	Ⓔ ATEX, UL
Increased Safety	ATEX Ex II 2GD, EExed IIC T6
Area Classification	Zones 1,2 and safe area.
Certified Ambient Temperature	-55°C to +50°C, Versions with switch -55°C to +45°C
Ingress Protection	IP65 & 66*
Material	Impact Resistant Thermo Plastic
Entries	1x M20 Bottom entry as standard
Weight	Approx. 1.3kg (model dependant)
Options	Pushbuttons, emergency stop, contact block, padlockable, rotary switches & block, potentiometer, lamps, gold contact block.

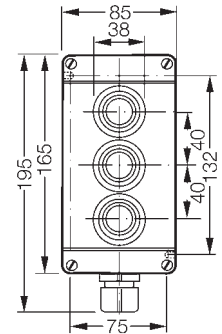

432 434 Range | Control Units – *Explosionproof & Weatherproof*



*Dependant on version

Certification	Ⓔ Ex, ATEX, UL
Area Classification	Zones 1,2 and safe area
Certified Ambient Temperature	-55°C to +50°C, Versions with switch -55°C to +45°C
Ingress Protection	IP65/66*
Material	Impact Resistant Thermo Plastic
Entries	2x M20 Bottom entry as standard
Weight	0.8kg to 1.6kg
Options	Pushbuttons, emergency stop, contact block, rotary switches & block, potentiometer, lamps, gold contact block.

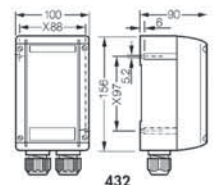
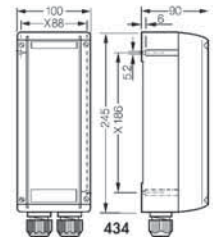

Explosionproof & Weatherproof – Terminal Boxes & Control Units | GHG 74 & 44 Range

A range of GRP or 316 Stainless Steel Terminal Boxes and Control Units. The Control Units can be fitted with a variety of lamps, switches, pushbuttons and other accessories.

Certification	⊕ ATEX, UL			
Increased Safety	ATEX Ex II 2GD, EExe II T4, T6*			
Ingress Protection	IP65/66*			
Area Classification	Model dependant - refer to datasheet			
Material	Corrosion-free GRP or 316 Stainless Steel			
Dimensions (mm):				
Box Type	Box Type	Width x	Height x	Depth*
444 23	744 01	271	134	136
448 23	745 02	271	271	136
449 23	746 02	544	271	136
471 23	749 04	817	271	136
444 33	744 21	175	312.5	151
448 33	745 22	312.5	312.5	151
449 33	146 23	312.5	312.5	151
447 33	749 24	941.5	312.5	151



*Dependant on version

Explosionproof & Weatherproof – Control Units & Motor Starters | GP1, 2, 3 & 4 , G2, JL Range

A range of custom built control and motor starter units which can be used individually or combined to provide hazardous area systems for indoor or outdoor use.

Certification	⊕ ATEX		
Flameproof	*ATEX EX II 2GD		
Ingress Protection	IP65 & 66		
Area Classification	Model dependant - refer to datasheet		
Material	Cast iron, Stainless Steel or Alloy *		
Dimensions (mm):			
	Width x	Height x	Depth
GP1/GP1S	580	480	240
GP2/GP2S	480	275	243
GP3/GP3S	580	480	365
JL4/2/JL4/2S	305	265	150
JL4/3/JL4/3S	305	265	237
G2/G2S	156	257	175

*Model dependant



Explosionproof & Weatherproof | Distribution Panels & Boards

A range of custom built distribution systems utilising Cooper MEDC's expertise in hazardous area applications to ensure a safe and reliable solution to customer specifications.

Certification	⊕ ATEX	
Flameproof	ATEX Ex II 2G, EExd IIB	
Ingress Protection	IP66	
Area Classification	Model dependant - refer to datasheet	
Material	Cast iron, Stainless Steel or Alloy. *	

*Model dependant





Heavy Duty Industrial & Marine

Cooper MEDC offer products suitable for Heavy Duty Industrial and Marine environments.

The Cooper MEDC range includes sounders, beacons, combination units in heavy duty designs with high ingress protection ratings.

Products conform to IP 66 & 67 ratings, as well as a variety of other globally recognised certifications.



Weatherproof & Heavy Duty – Break Glass Call Point | **BG3W**

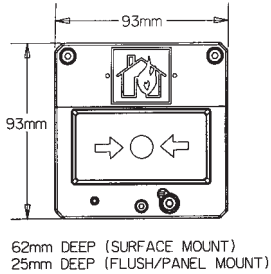

Area Classification	Model dependant - refer to datasheet
Operating Temperature	-55°C to +55°C
Ingress Protection	IP66 & 67
Material	Corrosion-free GRP
Entries	2 x 20mm
Weight	0.5kg
Options	Body colour, LED, lift flap, series & EOL resistors, tag & duty labels.



Weatherproof & Heavy Duty –10 Joule Flashing Xenon | **XB13**

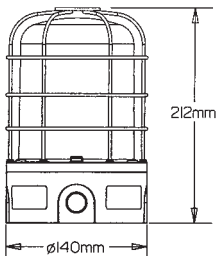

Area Classification	Weatherproof.
Operating Temperature	-55°C to +70°C
Ingress Protection	IP66 & 67
Material	Corrosion-free GRP body, Polycarbonate lens
Entries	Up to 3 x 20mm via knockouts
Weight	1.1kg
Options	Body & lens colour, tag & duty labels, lens guard, telephone & relay initiate, single & dual flash mode, voltages 12-24V d.c., 115-230V a.c.



Weatherproof & Heavy Duty – 110dB(A) Sounder | **DB12**

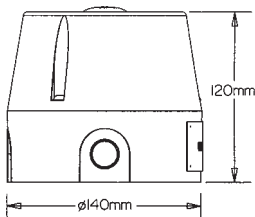

Area Classification	Weatherproof.
Operating Temperature	-55°C to +70°C
Ingress Protection	IP66 & 67
Material	Corrosion-free GRP
Entries	Up to 3 x 20mm via knockouts
Weight	1kg d.c 1.2kg a.c.
No. of Tones	27
Options	Body colour, tag & duty labels, voltages 12V & 24V d.c.



DB15 | 117dB(A) Sounder – *Weatherproof & Heavy Duty*



Area Classification	Weatherproof.
Operating Temperature	-55°C to +70°C
Ingress Protection	IP66 & 67
Material	Corrosion-free GRP
Entries	2 x 20mm
Weight	2.6kg
No. of Tones	27 + 5 programmable
Options	Painted grey, tag & duty labels, two stage alarm (DB15P) version, earth continuity, EOL resistor, voltages 12-48V d.c., *110-254V a.c.

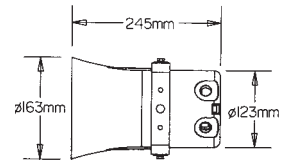

DB15P not available as a.c. version.

DB14 | 15 Watt Loudspeaker – *Weatherproof & Heavy Duty*



Area Classification	Weatherproof.
Ambient Operating Temperature	-55°C to +70°C
Ingress Protection	IP66 & 67
Material	Corrosion-free GRP
Output	107 dBA at 1W at 1 metre 117 dBA at 15W at 1 metre
Entries	2 x 20mm
Weight	2.6kg
Tappings	15, 7.5, 5, 4, 2, 0.8
Options	Painted grey, tag & duty labels, transformer voltage, BS 5839, part 8 compliance, earth continuity

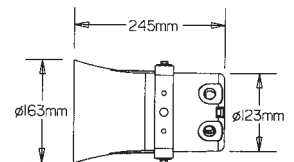

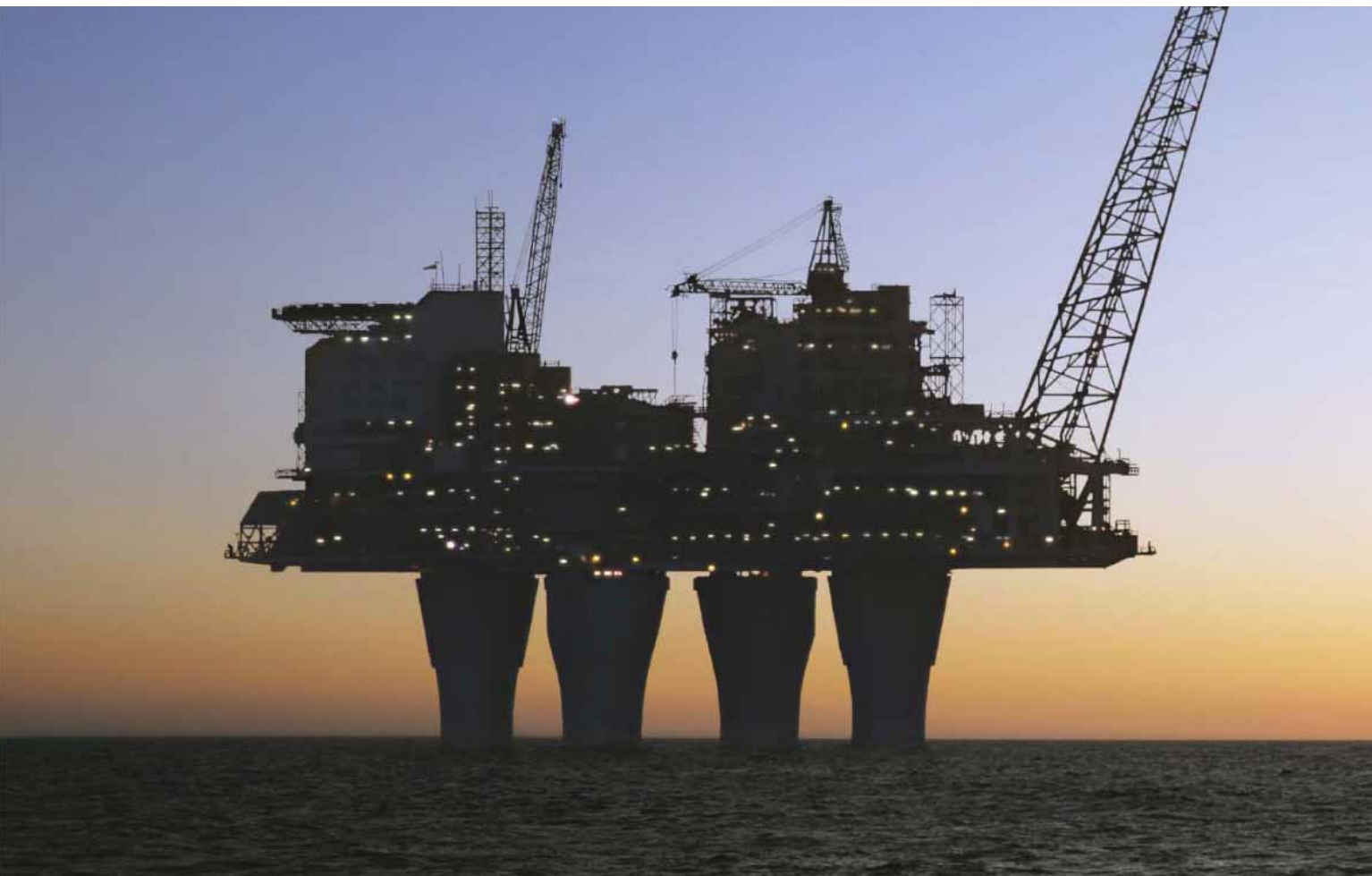

Cable Glands / Accessories

Complete termination solutions for cable applications meeting international standards.

Ease of cable termination providing labour and time management productivity.

Explosion-protected connections contributing to safe operation in harsh & hazardous environments.



ADE 1F | Non-armoured Gland

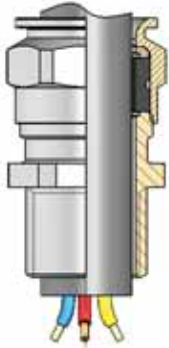

Certification	ATEX, IECEx, UL, CEPEL, GOST R, Lloyds, ABS, DNV
Area Classification	Class 1 Zone 2
Certified Ambient Temperature	-60°C to 100°C
Ingress Protection	NEMA 4X, IP66, IP67 & IP68 with additional sealing washers
Material	Nickel-Plated Brass (Standard)
Gland Size	4 to 16
Thread Range	M16 to M110 or 1/4" to 3 1/2" NPT
Cable Type	Non-armoured, armoured and tray cable (does not terminate the armour)
Options	Stainless Steel 316L, Bronze, Aluminium

1 Function - Inner Sealing Flameproof

ADE 1FC | Non-armoured Barrier Gland with Compound

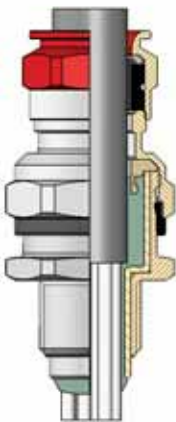

Certification	ATEX, IECEx, UL, CEPEL, GOST R, Lloyds, ABS, DNV
Area Classification	Class 1 Zone 2
Certified Ambient Temperature	-60°C to 80°C
Ingress Protection	NEMA 4X, IP66, IP67 & IP68
Material	Nickel-Plated Brass (Standard)
Gland Size	4 to 11
Thread Range	M16 to M63 or 3/8" to 2" NPT
Cable Type	Non-armoured, armoured and tray cable (does not terminate the armour)
Options	Stainless Steel 316L, Bronze, Aluminium

1 Function - Inner Sealing Flameproof

ADE 1FLC | Non-armoured Barrier Gland with Liquid Compound

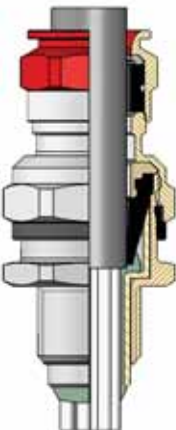

Certification	ATEX, IECEx, CEPEL, GOST R, Lloyds, DNV
Area Classification	Class 1 Zone 2
Certified Ambient Temperature	-60°C to 80°C
Ingress Protection	NEMA 4X, IP66, IP67 & IP68
Material	Nickel-Plated Brass (Standard)
Gland Size	4 to 7
Thread Range	M16 to M63 or 3/8" to 3/4" NPT
Cable Type	Non-armoured, armoured and tray cable (does not terminate the armour)
Options	Stainless Steel 316L, Bronze, Aluminium

1 Function - Inner Sealing Flameproof

Armoured Gland | ADE 4F

Certification	ATEX, IECEx, UL, CEPEL, GOST R, Lloyds, ABS, DNV
Area Classification	Class 1 Zone 2
Certified Ambient Temperature	-60°C to 100°C
Ingress Protection	NEMA 4X, IP66, IP67 & IP68
Material	Nickel-Plated Brass (Standard)
Gland Size	5 to 17
Thread Range	M12 to M110 or 1/4" to 4"NPT
Cable Type	Steel wire armoured, steel wire braided, steel tape armoured, braided marine shipboard and lead sheathed (with addition of earthing washer)
Options	Stainless Steel 316L, Bronze, Aluminium

4 Functions - Inner Sealing Flameproof + Outersealing IP, Mechanical Retention, Electrical Continuity

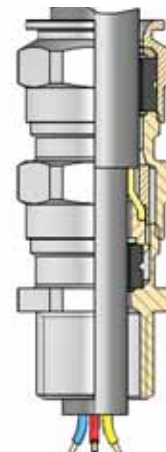

Armoured Gland | ADE 6F

Certification	ATEX, IECEx, UL, CEPEL, GOST R, Lloyds, ABS, DNV
Area Classification	Class 1 Zone 2
Certified Ambient Temperature	-60°C to 100°C
Ingress Protection	NEMA 4X, IP66, IP67 & IP68
Material	Nickel-Plated Brass (Standard)
Gland Size	5 to 11
Thread Range	M16 to M50 or 3/8" to 2"NPT
Cable Type	Steel wire armoured, steel wire braided, steel tape armoured and braided marine shipboard.
Options	Stainless Steel 316L, Bronze, Aluminium

6 Functions - Inner Sealing Flameproof + Outersealing IP, Mechanical Retention, Electrical Continuity + Armour Clamping, Deluge Proof

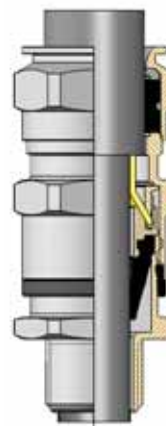

A Series | Cable Gland Accessories

Lock Nut	Nickel-Plated Brass
Sealing Washer	Neoprene
Earth Tag	Nickel-Plated Brass
Lock Washer	Stainless Steel 316L
Shroud	PVC
Clamping Module	Nickel-plated brass body with stainless steel screws and washers
Earthing Washer	Nickel-Plated Brass
Adapters/Reducers	Nickel-Plated Brass

Products for all ADE Series



PLUGS | Threaded Plugs

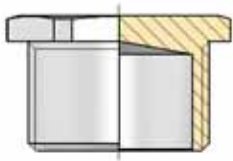

Certification	ATEX, IECEx, CEPEL, GOST R
Area Classification	Class 1 Zone 2
Certified Ambient Temperature	-60°C to 100°C
Ingress Protection	IP54/68 with additional sealing washers
Material	Nickel-Plated Brass (Standard)
Gland Size	M12 to M110 or 3/8" to 4"NPT
Thread Range	ISO / NPT others thread on request
Cable Type	None
Options	Stainless steel 316L, Bronze, Aluminium, and other material on request

ACCESSORIES | Thread Reducers, Adapters, Enlargers

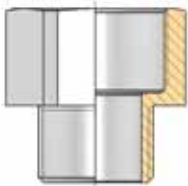

Certification	ATEX, IECEx, CEPEL, GOST R
Area Classification	Class 1 Zone 2
Certified Ambient Temperature	-60°C to 100°C
Ingress Protection	IP54/68 with additional sealing washers
Material	Nickel-Plated Brass (Standard)
Gland Size	M12 to M110 or 3/8" to 4"NPT
Thread Range	ISO / NPT others thread on request
Cable Type	None
Options	Stainless steel 316L, Bronze, Aluminium, and other material on request

Dimensions for all Glands and Accessories are available on request



© BP p.l.c

North American Certified Products

This section includes products which are internationally approved within North America.



SM87PB UL | Push Button Fire Alarm Call Point – *Explosionproof & Weatherproof*



North American Certifications	UL, ULC, CSA, Class I, Div 1, Groups C & D, Class I, Zone 1, IECEx
Area Classification	Model dependant - refer to datasheet
Certified Ambient Temperature	-67°F to +158°F -55°C to +70°C
Ingress Protection	NEMA 4x & 6 IP66 & 67
Material	Marine Grade Alloy
Entries	Up to 4 x ½" or ¾" NPT
Weight	5.5lb/2.5kg
Options	Body color, tag & duty labels, LED, series or EOL resistor, diode, addressable module, certification

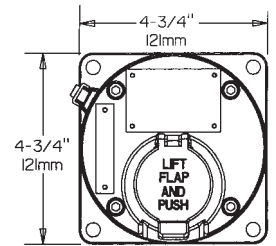

5-3/16" / 132mm DEEP

BG UL | Break Glass Fire Alarm Call Point – *Hazardous Locations*



Standard models stocked in U.S.
- contact the U.S. sales office

North American Certifications	UL, Class I, Div 2, Groups A, B, C & D, Class I, Zone 2
Area Classification	Model dependant - refer to datasheet
Certified Ambient Temperature	-13°F to +131°F -25°C to +55°C
Ingress Protection	NEMA 4x & 6 IP66 & 67
Material	Corrosion-free GRP
Entries	Up to 4 x ½" NPT
Weight	2.6lb/1.2kg
Options	Body color, tag & duty labels, LED, liftflap, series or EOL resistor, plastic element, single or double pole switch, certification

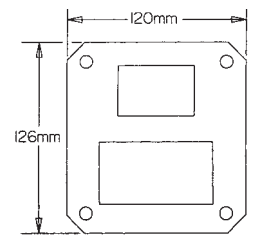

75mm DEEP

Standard models.
Available ex-stock.

Ordering Code
PX869101

Product description
BGUL4C6C1DSN6R

PB UL | Push Button Fire Alarm Call Point – *Hazardous Locations*



Standard models stocked in U.S.
- contact the U.S. sales office

North American Certifications	UL, CSA, Class I, Div 2, Groups A, B, C & D, Class I, Zone 2
Area Classification	Model dependant - refer to datasheet
Certified Ambient Temperature	-13°F to +131°F -25°C to +55°C
Ingress Protection	NEMA 4x & 6 IP66 & 67
Material	Corrosion-free GRP
Entries	Up to 4 x ½" NPT
Weight	2.6lb/1.2kg
Options	Body color, tag & duty labels, LED, series or EOL resistor, single or double pole switch, certification

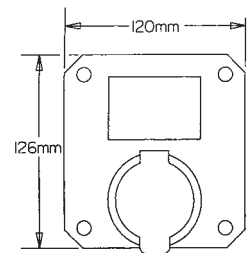

114mm DEEP

Standard models.
Available ex-stock.

Ordering Code
PX869105

Product description
PBUL4C6C0DSN7R

SL15 UL | Status Lights – *Explosionproof & Weatherproof*



UL Version

Certification	UL, ATEX, and IECEx Approved
Area Classification	Model dependant - refer to datasheet
Certified Ambient Temperature	-55°C to +70°C
Ingress Protection	IP66 & 67
Material	Corrosion-free GRP
Entries	Up to 2 x ½" or 2 x ¾" entries. ATEX has M20 or M25.
No. of Ways	Up to 4
Options	Various flash rates available for xenon units. Various lens colours. Optional cast or wire lens guard.

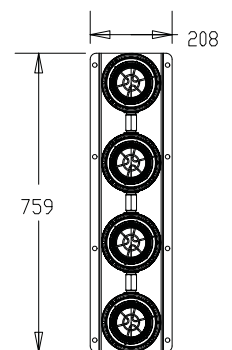

250mm DEEP

Explosionproof & Weatherproof – Xenon, Filament & Fluorescent Status Lights | SM87SL UL

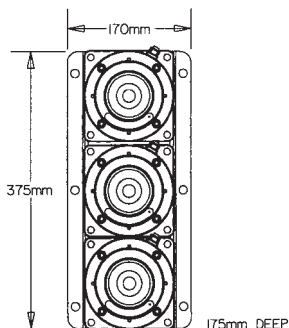

North American Certifications	UL, CSA, Class I, Div 1, Groups C & D, Class I, Zone 1, AExd IIB T4, T6, IECEx
Area Classification	Model dependant - refer to datasheet
Certified Ambient Temperature	-13°F to +131°F -25°C to +55°C*
Ingress Protection	NEMA 4x & 6 IP66 & 67
Material	Alloy
Entries	Up to 3 x ½" or ¾" NPT
No. of Lights	2, 3, 4 or 5
Options	Body & lens colour, tag & duty labels, certification, voltages 24-48V d.c., 110-254V a.c.



*Model dependant, refer to data sheet.

Hazardous Locations – Xenon & Filament Status Lights | XB11SL UL

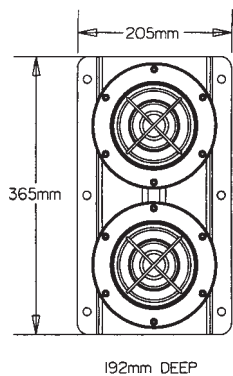

North American Certifications	UL, Class I, Div 2, Groups C & D, Class 1, Zones 1 & 2, AExd IIB T4, IECEx
Area Classification	Model dependant - refer to datasheet
Certified Ambient Temperature	-67°F to +158°F -55°C to +70°C
Ingress Protection	NEMA 4x & 6 IP66 & 67
Material	Corrosion-free GRP
Entries	1 x ½" NPT
No. of Lights	2, 3, 4, or 5
Options	Body & lens color, tag & duty labels.



Hazardous Locations – Xenon & Filament Status Lights | XB12SL UL

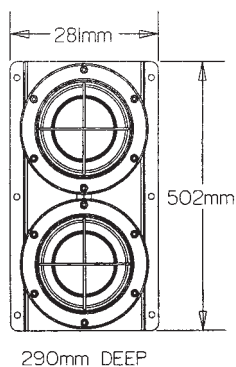

North American Certifications	UL, Class I, Div 2, Groups C & D, Class I, Zones 1 & 2, AExd IIB T4, T5, IECEx
Area Classification	Model dependant - refer to datasheet
Certified Ambient Temperature	-67°F to +158°F -55°C to +70°C
Ingress Protection	NEMA 4x & 6 IP66 & 67
Material	Corrosion-free GRP
Entries	1 x ½" NPT
No. of Lights	2, 3, 4 or 5
Options	Body & lens color, tag & duty labels, certification, voltages 24V d.c., 110-254V a.c.



SM87 HXB UL | 5 Joule Xenon Strobe – Explosionproof & Weatherproof



North American Certifications	UL, CSA, Class I, Div 1, Groups C & D, Class I, Zone 1, AExd IIB, IECEx
Area Classification	Model dependant - refer to datasheet
Certified Ambient Temperature	-67°F to +158°F -55°C to +70°C
Ingress Protection	NEMA 4x & 6 IP66 & 67
Material	Alloy
Entries	Up to 4 x 1/2" or 3/4" NPT
Weight	4.4lb/2.0kg approx
Options	Body & lens color, tag & duty labels, certification, lens guard, flash rate, voltages 24-48V d.c., 110-254V a.c., high temp version up to 185°F/85°C

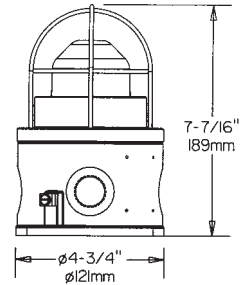

Standard model stocked in U.S. - contact the U.S. sales office

XB11 UL | 5 Joule Xenon Strobe – Hazardous Locations



North American Certifications	UL, Class I, Div 2, Groups C & D, Class I, Zones 1 & 2, AExd IIB T5, IECEx
Area Classification	Model dependant - refer to datasheet
Certified Ambient Temperature	-67°F to +158°F -55°C to +70°C
Ingress Protection	NEMA 4x & 6 IP66 & 67
Material	Corrosion-free GRP
Entries	2 x 1/2" NPT
Weight	5 1/2 lb 2.5kg
Options	Body & lens color, tag & duty labels, lens guard, flash rate, certification, mounting method. voltages 24V d.c., 110-254V a.c.

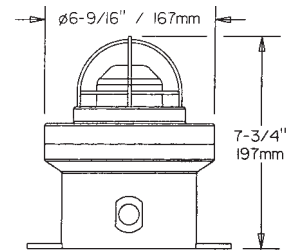

Standard model stocked in U.S. - contact the U.S. sales office

Standard models. Available ex-stock.	Ordering Code PX869174	Product description XB11UL02406CNBNNNR
---	---------------------------	---

XB16 UL | 10 Joule Flashing Xenon – Hazardous & Ordinary Locations



North American Certifications	UL 1971 compliant*, Class I, Div 2, Groups A-D Class II, Div 2, Groups F & G, IECEx
Area Classification	Model dependant - refer to datasheet
Certified Ambient Temperature	-67°F to +158°F -55°C to +70°C
Ingress Protection	NEMA 4x & 6 IP66 & 67
Material	Corrosion-free GRP
Entries	Standard 1 x 3/4" NPT
Weight	2.2lb/1kg
Options	Body & lens color, lens guard, tag & duty labels, initiation options, flash rate, voltages 24-48V d.c., 110-254V a.c.

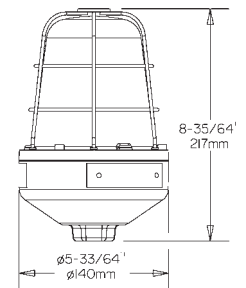

* UL1971 version only available with clear lens option

Standard model stocked in U.S. - contact the U.S. sales office

Standard models. Available ex-stock.	Ordering Code PX869407	Product description XB16UL12060RYNN
---	---------------------------	--

Hazardous & Ordinary Locations – 15 Joule Flashing Xenon | XB15 UL

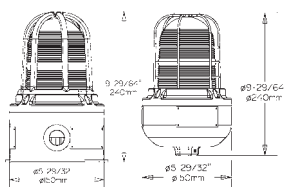

Direct Mount Pipe Mount

North American Certifications	UL, ULC, Class I, Div 2, Groups A, B, C, D Class II, Div 2, Groups F&G, Class I, Zone 1, AExd IIC T4, T5, T6, IECEx
Area Classification	Model dependant - refer to datasheet
Certified Ambient Temperature	-67°F to +158°F -55°C to +70°C
Ingress Protection	NEMA 4x & 6 IP66 & 67
Material	Corrosion-free GRP
Entries	Up to 3 x 1/2" NPT or 3 x 3/4" NPT Pipe mount = 1 x 1/2" or 1 x 3/4" NPT
Weight	5 3/4lb/2.6kg Pipe Mount 6 1/2lb/3.0kg Direct Mount
Options	Body & lens color, relay initiate, flash rate, voltages 24-48V d.c., 110-254V a.c.



Hazardous Locations – 21 Joule Xenon Strobe | XB12 UL

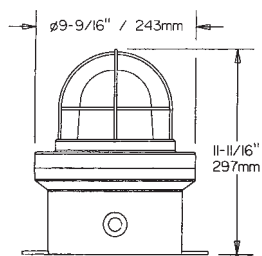

North American Certifications	UL, Class I, Div 2, Groups C & D, Class I, Zones 1 & 2, AExd IIB T4, T5, IECEx
Area Classification	Model dependant - refer to datasheet
Certified Ambient Temperature	-67°F to +158°F -55°C to +70°C
Ingress Protection	NEMA 4x & 6 IP66 & 67
Material	Corrosion-free GRP
Entries	Up to 2 x 1/2" NPT
Weight	15.5lb/7.0kg
Options	Body & lens color, tag & duty labels, lens guard, flash rate, certification, mounting method voltages 24V d.c., 110-254V a.c.



Explosionproof & Weatherproof – 21 Joule Xenon Strobe | XB4 UL

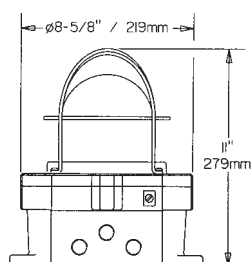

North American Certifications	UL, Class I, Div 1, Groups C & D, Class I, Zone 1, AExd IIB T4, IECEx
Area Classification	Model dependant - refer to datasheet
Certified Temperature	-67°F to +158°F -55°C to +70°C
Ingress Protection	NEMA 4x & 6 IP66 & 67
Material	Alloy or Stainless Steel
Entries	Up to 3 x 1/2" or 3/4" NPT
Weight	14.5lb/6.6kg LM Alloy
Options	Body & lens color, tag & duty labels, lens guard, flash rate, certification, voltages 24V d.c., 110V & 240V a.c.



SM87 LU3 UL | LU3 UL 10 Watt Steady Filament Light – *Explosionproof & Weatherproof*



North American Certifications	UL, CSA, Class I, Div 1, Groups C & D, Class I, Zone 1, AExd IIB, IECEx
Area Classification	Model dependant - refer to datasheet
Certified Temperature	-67°F to +131°F -55°C to +55°C
Ingress Protection	NEMA 4x & 6 IP66 & 67
Material	Alloy
Entries	2 x 1/2" or 3/4" NPT
Weight	4.4lb/2.0kg
Options	Body & lens colour, tag & duty labels, lens guard, certification, voltages 12, 24, 48V d.c., 110V-254V a.c.

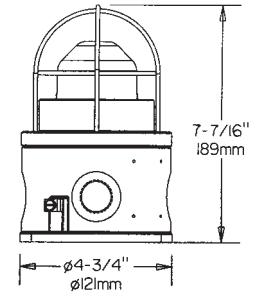

Standard model stocked in U.S. - contact the U.S. sales office

FB11 UL | 10 Watt Steady Filament Light – *Hazardous Locations*



North American Certifications	UL, Class I, Div 2, Groups C & D, Class I, Zone 1, AExd IIB T4, T5, IECEx
Area Classification	Model dependant - refer to datasheet
Certified Temperature	*-67°F to +131°F -55°C to +55°C
Ingress Protection	NEMA 4x & 6 IP66 & 67
Material	Corrosion-free GRP
Entries	Up to 2 x 1/2" NPT
Weight	6.2lb/2.8kg
Options	Body & lens color, tag & duty labels, lens guard, mounting method, certification, voltage 24, 48V d.c., 110 – 120V a.c.

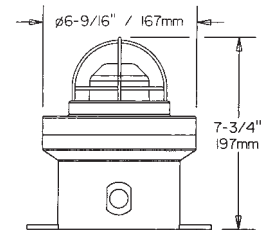

*Model dependant

FB12 UL | 60/100 Watt Steady Filament Light – *Hazardous Locations*



North American Certifications	UL, Class I, Div 2, Groups C & D, Class I, Zone 1, AExd IIB T4, T5, IECEx
Area Classification	Model dependant - refer to datasheet
Certified Temperature	*-67°F to +131°F -55°C to +55°C
Ingress Protection	NEMA 4x & 6 IP66 & 67
Material	Corrosion-free GRP
Entries	Up to 2 x 1/2" NPT
Weight	16.7lb/7.6kg
Options	Body & lens color, tag & duty labels, lens guard, mounting method, certification, voltage 120V a.c.

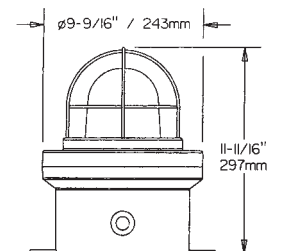

*Model dependant

Hazardous & Ordinary Locations – 60W Steady Filament Light | FB15 UL

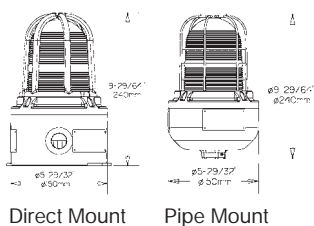

North American Certifications	UL, Class I, Div 2, Groups A,B,C, & D Class I, Zone 1, AExd IIC T3, T4, IECEX
Area Classification	Model dependant - refer to datasheet
Certified Temperature	*-67°F to +158°F -55°C to +70°C
Ingress Protection	NEMA 4x & 6 IP66 & 67
Material	Corrosion-free GRP / Metal Cover for Pipe Mounted Unit
Entries	Up to 3 x 1/2" NPT or 3 x 3/4" NPT
Weight	5 3/4lb/2.6kg Pipe Mount 6 1/2lb/3.0kg Direct Mount
Options	Body & lens color, lens guard, tag & duty labels, lamp wattage, unit fixing, mounting method, voltages 24-48V d.c., 110-254V a.c.



*Model dependant

Explosionproof & Weatherproof – 60 Watt Steady Filament Light | FB4 UL

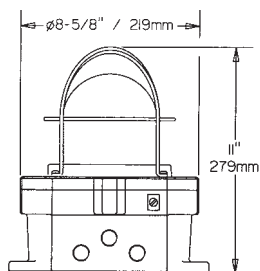

North American Certifications	UL Ex ATEX, Class I, Div 1, Groups C & D, Class I, Zone 1, AExd IIB T3, T4, IECEX
Area Classification	Model dependant - refer to datasheet
Certified Temperature	-67°F to +131°F -55°C to +55°C
Ingress Protection	NEMA 4x & 6 IP66 & 67
Material	Alloy
Entries	Up to 3 x 1/2" or 2 x 3/4" NPT
Weight	*13lb/6.4kg
Options	Body & lens color, tag & duty labels, lens guard, relay initiate, certification, voltage 24V d.c., 110V a.c.



*Model dependant

Explosionproof & Weatherproof – 10 Watt Steady Fluorescent Light | SM87 LU1 UL

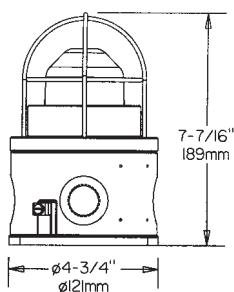

North American Certifications	UL, CSA, Class I, Div 1, Groups C & D, Class I, Zone 1, AExd IIB, IECEX
Area Classification	Model dependant - refer to datasheet
Certified Temperature	-67°F to +131°F -55°C to +55°C
Ingress Protection	NEMA 4x & 6 IP66 & 67
Material	Alloy
Entries	2 x 1/2" or 3/4" NPT
Weight	4.4lb/2.0kg
Options	Body & lens colour, tag & duty labels, lens guard, certification, voltages 24-48V d.c. 220V-254V a.c.



FL4 UL | 13-39 Watt Steady Fluorescent Light - *Explosionproof & Weatherproof*



North American Certifications	UL, Class I, Div 1, Groups C & D, Class I, Zone 1, AExd IIC T5, IECEx
Area Classification	Model dependant - refer to datasheet
Certified Temperature	-4°F to +131°F -20°C to +55°C
Ingress Protection	NEMA 4x & 6 IP66 & 67
Material	Alloy
Entries	Up to 3 x 1/2" NPT or 3 x 3/4" NPT
Weight	*14.5lb/6.6kg
Options	Body & lens color, tag & duty labels, lens guard, relay initiate, certification, voltages 24V d.c., 110V, 240V a.c.

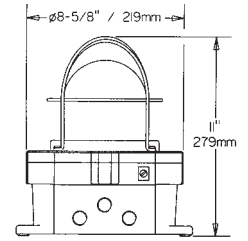

*Model dependant

DB5 FM UL | FM Up to 93dB(A) @ 10ft Horn - *Intrinsically Safe*



North American Certifications	UL, FM, CSA, Class I, Div 1 & 2, Groups A,B,C & D, IECEx
Area Classification	Model dependant - refer to datasheet
Certified Temperature	-4°F to +131°F -20°C to +55°C
Ingress Protection	NEMA 4 IP65
Material	Corrosion-free ABS
Entries	Up to 2 x 13/16" via knockouts
Weight	0.7lb/0.3kg
No. of Tones	26
Options	Body color, label, certification, voltages 12V-24V d.c.

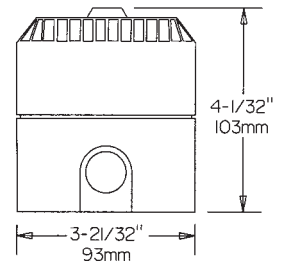

Standard models stocked in U.S. – contact the U.S. sales office.

DB1HP UL | 103dB(A) @ 10ft Horn - *Explosionproof & Weatherproof*



North American Certifications	UL, Class I, Div 1, Groups C & D, Class I, Zone 1, IECEx
Area Classification	Model dependant - refer to datasheet
Certified Temperature	-13°F to +158°F -25°C to +70°C
Ingress Protection	NEMA 4x IP66
Material	Alloy
Entries	Up to 3 x 1/2" or 3/4" NPT
Weight	7.7lb/3.5kg (model dependant)
No. of Tones	27 + 5 Programmable
Options	Body color, tag & duty labels, certification, voltages 12,24,48V d.c., 110V a.c.

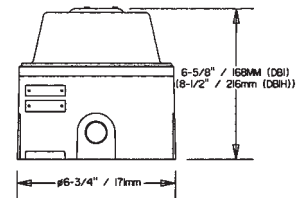

Standard models stocked in U.S. – contact the U.S. sales office.

Hazardous Locations -115dB(A) @ 1m Horn | DB3 UL

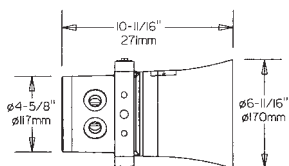

North American Certifications	UL, ULC, Class I, Div 2, Groups A,B,C & D Class II, Div 2, Groups F & G Class I, Zones 1 & 2, AExd IIC T4, IECEX
Area Classification	Model dependant - refer to datasheet
Certified Temperature	-67°F to +158°F -55°C to +70°C
Ingress Protection	NEMA 4x & 6 IP65 & 67
Material	Corrosion-free GRP
Entries	Up to 2 x 1/2" NPT
Weight	11lb/5.0kg
No. of Tones	27 + 5 Programmable
Options	Body color, tag & duty labels, end of line resistor, certification, voltages 12-48V d.c., 110V-254V a.c.



Standard model stocked in U.S. – contact the U.S. sales office.

Standard models. Available ex-stock.	Ordering Code PX869131	Product description DB3UL048N2CNRZ
---	---------------------------	---------------------------------------

Hazardous Locations - 8-25 Watt Loudspeaker | DB4 UL

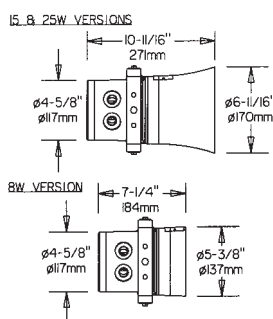

North American Certifications	UL, Class I, Div 2, Groups A,B,C & D, Class I, Zone 1, AExd IIC T4, IECEX
Area Classification	Model dependant - refer to datasheet
Certified Temperature	-67°F to +158°F -55°C to +70°C
Ingress Protection	NEMA 4x & 6 IP66 & 67
Material	Corrosion-free GRP
Entries	Up to 2 x 1/2" NPT
Weight	11lb/5.0kg
Output	97 dBA at 1W at 10 feet 109 dBA at 25W at 10 feet
Options	Body color, tag & duty labels, transformer, certification, power 25W, 15W, 8W



Hazardous Locations - 30 Watt Loudspeaker | DB16 UL

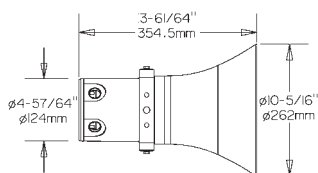

North American Certifications	UL, Class I, Div 2, Groups C & D/A-D Class I, Zone 1, AExde IIB T3/IIC T110°C
Area Classification	Model dependant - refer to datasheet
Certified Temperature	-61°F to +90°F -50°C to +40°C
Ingress Protection	NEMA 4x & 6 IP66 & 67
Material	Corrosion-free GRP
*Output	Groups C & D: 100dBA at 1Watt at 10 feet 112dBA at 30 Watts at 10 feet Groups A-D: 3dBA less than C & D versions
Entries	Up to 2 x 1/2" NPT or 2 x 3/4" NPT
Weight	12.1lb/5.5kg
Tappings @ 30 Watts	30, 25, 12, 6, 4, 2
Options	Body color, transformer, tag & duty labels.



*See data sheet for additional output.

GHG 41181 UL | Control Units – Hazardous Locations



North American Certifications	UL, Class I, Div 2, Groups A,B,C & D Class I, Zone 1, AExde IIB+H2 T6 Class II, Div 1, Groups E,F&G(cUL)
Area Classification	Model dependant - refer to datasheet
Certified Temperature	-4°F to + 104°F -20°C to +40°C
Ingress Protection	NEMA 4x & 6, IP65 & 66
Material	Impact Resistant Thermo Plastic
Entries	1 x ½" NPT as standard
Weight	0.5kg - 1.3kg
Options	Pushbuttons, emergency stop, padlockable, contact block, rotary switches & block, potentiometer, lamps

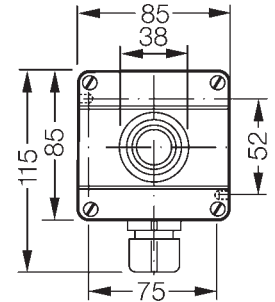

GHG 41182 UL | Control Units – Hazardous Locations

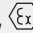

North American Certifications	UL,  ATEX, Class I, Div 2, Groups A,B,C & D Class I, Zone 1, AExde IIB+H2 T6 Class II, Div 1, Groups E,F&G(cUL)
Area Classification	Model dependant - refer to datasheet
Certified Temperature	-4°F to + 104°F -20°C to +40°C
Ingress Protection	NEMA 4x & 6, IP65 & 66
Material	Impact Resistant Thermo Plastic
Entries	1 x ½" NPT as standard
Weight	0.5kg - 1.3kg
Options	Pushbuttons, emergency stop, padlockable, contact block, rotary switches & block, potentiometer, lamps

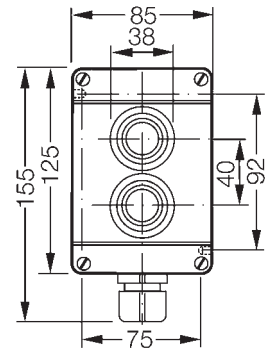

GHG 41183 UL | Control Units – Hazardous Locations



North American Certifications	UL, Class I, Div 2, Groups A,B,C & D Class I, Zone 1, AExde IIB+H2 T6 Class II, Div 1, Groups E,F&G(cUL)
Area Classification	Model dependant - refer to datasheet
Certified Temperature	-4°F to + 104°F -20°C to +40°C
Ingress Protection	NEMA 4x & 6, IP65 & 66*
Material	Impact Resistant Thermo Plastic
Entries	1 x ½" NPT as standard
Weight	0.5kg - 1.3kg
Options	Pushbuttons, emergency stop, padlockable, contact block, rotary switches & block, potentiometer, lamps

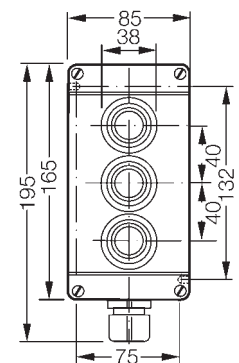

*Model dependant

EExed & Weatherproof | 432 434 Range



North American Certification	UL ATEX,
Area Classification	Class I, Zone 1, AExde IIB+H2 T6 Class II, Div 1, Groups E,F&G(cUL)
Certified Ambient Temperature	-4°F to + 104°F -20°C to +40°C
Ingress Protection	NEMA 4x & 6, IP65 & 66*
Material	Impact Resistant Thermo Plastic
Entries	2 x 1/2" NPT as standard
Weight	1.75lbs-3.5lbs / 0.8kg-1.6kg
Options	Pushbuttons, emergency stop, padlockable, contact block, rotary switches & block, potentiometer, lamps.



*Model dependant

Explosionproof & Weatherproof - GRP Junction Boxes | JB10 & JB11 UL

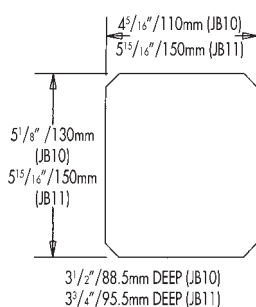

North American Certifications	UL Class I, Div 2, Groups A,B,C & D Class I, Zone 1, AExe IIC T4, T5
Area Classification	Model dependant - refer to datasheet
Certified Temperature	-67°F to + 131°F -55°C to +55°C
Ingress Protection	NEMA 4x & 6, IP66 & 67
Material	Corrosion-free GRP
Entries	Up to 8 entries (model dependant)
Weight	2.4-4lbs/1.1kg-1.8kg
Options	Body color, tag label, gland continuity, extra internal earth, terminal type



A range of GRP Terminal Boxes and Control Units. The Control Units can be fitted with a variety of lamps, switches, pushbuttons and other accessories.

Hazardous Locations - Terminal Boxes & Control Units | GHG 74 & 44 UL

North American Certifications	UL	
Increased Safety	Class I, Div 2, Groups A,B,C & D Class I, Zone 1, Groups A,B,C & D Class II, Div 1, Groups E, F & G AExde IIC T4, T6*	
Area Classification	Model dependant - refer to datasheet	
Ingress Protection	IP65/66*	
Material	Corrosion-free GRP or 316 Stainless Steel	
Dimensions (mm):		
Box Type	Box Type	Width x Height x Depth*
444 23	744 01	271 134 136
448 23	745 02	271 271 136
449 23	746 02	544 271 136
471 23	749 04	817 271 136
444 33	744 21	175 312.5 151
448 33	745 22	312.5 312.5 151
449 33	146 23	312.5 312.5 151
447 33	749 24	941.5 312.5 151



*Model dependant

All specifications, dimensions, weights and tolerances are nominal (typical) and MEDC reserve the right to vary all data without prior notice. No liability is accepted for any consequence of use.

New Express Service



Express Service

Cooper MEDC is proud to announce the launch of our new Express Service for the XB15.

As a direct result of customer feedback the Cooper MEDC Express Service has been developed to meet the increasing demand for reduced lead time for customized products.

Our Express Service helps customers meet tighter deadlines with more flexibility, conforming to your specification at a moment's notice.

This is another step forward for Cooper MEDC helping you get what you need, when you need it, as an extension to the quality and service our customers have come to expect.



XB15	U.K. Manufactured	U.S.A Manufactured
Certification	ATEX	UL
From Point Order shipped within	5 Working Days	2 Working Days
Order Quantities	Up to 15 Units per Configuration	Up to 15 Units per Configuration
Mounting	Direct Mount, With or Without a Backstrap.	Pipe Mount
Voltages	24V d.c., 48V d.c., 230V a.c. and 240V a.c.	24V d.c. or 120V a.c.
Lens Colour	Red, Blue, Amber or Yellow	Red, Blue, Amber or Clear
Body Colour	Natural Black or Red (Red Body Only Available With Red Lens)	Natural Black
Lens Guard	None, Wire	None, Cast or Wire
Tags	Tag Label Option (Please specify wording)	Tag Label Option (Please specify wording)

Cooper MEDC

Expert in hazardous area applications.

- Over 30 years commitment to design and development.
- Full in house manufacturing capability.
- Quality Assurance to ISO 9001, Environmental Management ISO 14001 & Occupational Health & Safety OHSAS 18001
- Leader in GRP products for hazardous areas.
- 2 year warranty.
- Ex-stock to 4 weeks delivery.



Cooper MEDC Worldwide



End users



Cooper MEDC Limited
Colliery Road
Pinxton, Nottingham
NG16 6JF

T: +44 (0)1773 864 100
F: +44 (0)1773 582 800
www.coopermedc.com

Cooper MEDC (USA)
3413 North Sam Houston
Parkway West
Houston, TX 77086, USA

T: +1 (713)937 9772
F: +1 (713)937 9773

The trade names and brand names contained herein are valuable trademarks of Cooper Industries in the U.S. and other countries. You are not permitted to use the Cooper Trademarks without the prior written consent of Cooper Industries.

Cooper Industries plc
600 Travis, Suite 5600
Houston, TX 77002-1001
T: 713-209-8400
www.cooperindustries.com

The logo for Cooper Industries, featuring the word "COOPER" in a bold, black, sans-serif font. Above the letter "O" is a red, slanted rectangular bar.

PXMKPR003